

THIS DRAWING IS A CONTROLLED DOCUMENT AND THE CONTROLLING ORGANIZATION AND SHOULD BE CONTACTED FOR THE LATEST REVISION.

THIS INFORMATION IS CONFIDENTIAL AND IS TO BE RELEASED ONLY ON WRITTEN REQUEST TO THE ORIGINAL AUTHOR OR TO THE ORIGINAL AUTHOR'S SUCCESSOR. IT IS THE PROPERTY OF AMP INCORPORATED, HARRISBURG, PA.

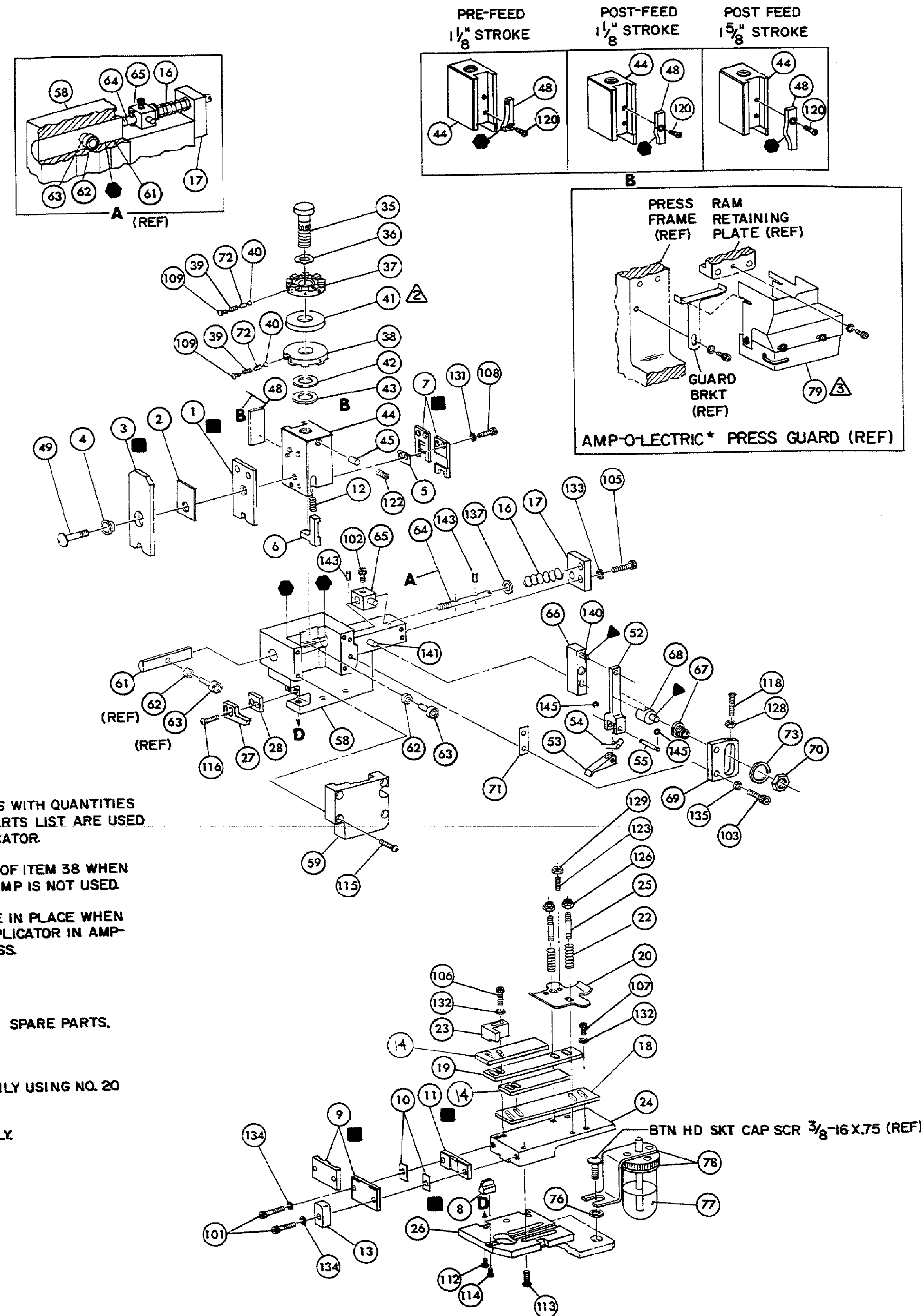

NOTES:
 1. ONLY THE ITEMS WITH QUANTITIES SPECIFIED ON PARTS LIST ARE USED ON THIS APPLICATOR.

▲ USED IN PLACE OF ITEM 38 WHEN INSULATION CRIMP IS NOT USED.

▲ GUARD MUST BE IN PLACE WHEN OPERATING APPLICATOR IN AMP-O-LECTRIC PRESS.

KEY:
 ■ RECOMMENDED SPARE PARTS.
 ▲ LUBRICATE DAILY USING NO. 20 MACHINE OIL.
 ● GREASE LIGHTLY.

QTY	PART NO	DESCRIPTION	ITEM NO	QTY	PART NO	DESCRIPTION	ITEM NO
2	21045-3	RING, RETAINING 'C' (.187 DIA) FEED PIN	145	1	454220-1	CAP, RAM	59
			144	1	453736-1	HOUSING	58
2	5-21028-1	PIN, SLOT SPG (.12 DIA X .50) FD ADJ ROD	143				57
			142				56
1	1-21030-7	PIN, DOWEL (.187 DIA X 1.50) HOUSING	141	1	240624-1	PIN, FEED FINGER	55
1	1-21030-1	PIN, DOWEL (.187 DIA X .50) LEVER	140	1	691499-1	SPRING, FEED FINGER	54
			139	1	694921-8	FINGER, FEED	53
			138	1	240634-1	LEVER, TERMINAL	52
			137				51
			136				50
2	21024-5	WASHER, LOCK (NO 10) FEED ADJ PLATE	135	1	7-21002-9	BOLT, CRIMPER	49
2	21024-5	WASHER, LOCK (NO 10) SHEAR PLATES	134	1	690602-E	CAM, PRE FEED 1 1/8 STROKE	48
2	21024-5	WASHER, LOCK (NO 10) FEED ROD GUIDE	133				47
5	21024-4	WASHER, LOCK (NO 8) STRIP GUIDE	132				46
2	21024-4	WASHER, LOCK (NO 8) SHEAR BLADE	131	1	690191-1	PLUG, NYLON	45
			130	1	455674-2	RAM	44
2	21018-4	NUT, HEX MACH (4-40) DRAG	129	1	690125-1	WASHER, LAMINATED	43
1	21018-5	NUT, HEX MACH (6-32) FD ADJ PLATE	128	1	690124-1	WASHER, RAM	42
			127			SPACER, DISC	41
2	21022-2	NUT, HEX SELF-LKG (8-32) DRAG STUD	126	2	23241-6	BALL, STEEL	40
			125	2	690170-1	SPRING, COMPRESSION	39
			124	1	690142-1	DISC, INSULATION	38
2	4-21078-8	SCR, SKT SET OVAL POINT (4-40 X .75) DRAG	123	1	2-690141-4	DISC, WIRE	37
1	21009-2	SCR, SKT SET (1/4-20 X 25) (LOC-WEL) RAM	122	1	22480-5	WASHER, SPRING	36
			121	1	690212-1	POST, RAM	35
1	1-21002-7	SCR, BTN HD SKT CAP (6-32 X .38) CAM	120				34
			119				33
1	6-23715-5	SCR, PAN HD MACH (6-32 X 1.50) FEED ADJ	118		458980-	APPLICATOR, BASIC (SUB ASSY)	32
			117				31
			116				30
2	2-21002-2	SCR, BTN HD SKT CAP (8-32 X .50) STRIPPER	115				29
4	2-21002-9	SCR, BTN HD SKT CAP (10-32 X .75) HSG CAP	114		1-690451-1	SPACER, STRIPPER	28
1	22733-8	SCR, BTN HD SKT CAP (8-32 X .38) (LOC-WEL) ANVIL	113	1	240639-1	STRIPPER	27
4	3-21002-3	SCR, BTN HD SKT CAP (1/4-20 X .50) STR GDE PL	112	1	455676-1	PLATE, BASE	26
3	17177-1	SCR, BTN HD SKT CAP (1/4-20 X .62) BASE PL	111	2	22354-8	DRAG, STUD	25
			110	1	455673-1	PLATE, STRIP GUIDE	24
			109			PLATE, STRIP HOLD	23
2	23030-1	SCR, SKT HD CAP (6-32 X .25) (LOC-WEL) CP DISC	108	2	4-22281-1	SPRING, DRAG	22
2	7-21000-4	SCR, SKT HD CAP (8-32 X .31) SHEAR BLADE	107				21
2	2-21000-6	SCR, SKT HD CAP (8-32 X .38) STRIP GUIDE	106	1	454177-1	DRAG, STOCK	20
3	2-21000-7	SCR, SKT HD CAP (8-32 X .50) STRIP GUIDE	105	1	458030-8	GUIDE, STRIP (REAR)	19
2	3-21000-7	SCR, SKT HD CAP (10-32 X .75) FD ROD GUIDE	104	1	458031-8	GUIDE, STRIP (FRONT)	18
			103	1	454178-1	GUIDE, FEED ROD	17
2	3-21000-6	SCR, SKT HD CAP (10-32 X .62) FD ADJ PLATE	102	1	4-22284-9	SPRING, FEED RETURN	16
1	3-21000-4	SCR, SKT HD CAP (10-32 X .38) PIVOT BLK	101				15
2	3-21000-8	SCR, SKT HD CAP (10-32 X .88) SHEAR PLATE	101				14
REF	455745-1	GUARD, WINDOW	79	2	463450-1	GUIDE, FEED FINGER	13
	465184-9	LUBRICATOR ASSY	78			SPACER, HOLD DOWN	12
	561230-3	OIL, LUBRICATING	77			SPRING, HOLD DOWN	11
	454406-1	SPACER, LUB BRACKET	76	1	240644-1	PLATE, REAR SHEAR	10
			75			SPACER, SHEAR PLATE	9
			74	1	2-690482-5	PLATE, FRONT SHEAR	8
	458109-1	WASHER, FLAT (SPECIAL)	73	1	3-240654-6	ANVIL	7
2	690603-1	SPRING, ASSIST	72	1	2-690474-9	BLADE, SLUG	6
1	690517-1	SPACER	71			HOLD DOWN, TERMINAL	5
1	22594-8	NUT, HEX	70	1	4-240641-3	SPACER, SHEAR BLADE	4
1	240628-1	PLATE, ADJ	69	1	238009-8	SPACER, TUBULAR	3
1	240626-1	SHAFT, PIVOT	68	1	6-456135-5	CRIMPER, INSULATION	2
1	240633-1	BUSHING	67	1	455888-1	SPACER, INSULATION	1
1	455680-1	LEVER, INTERMEDIATE	66	1	1-456103-6	CRIMPER, WIRE	
1	240629-1	BLOCK, PIVOT	65				
1	240632-2	SCREW, ADJ	64				
1	240659-3	PIN, CAM ROLLER	63				
1	240658-1	CAM, ROLLER	62				
1	454398-1	ROD, FEED	61				

CRIMPING DATA				APPLICATOR WILL APPLY	
PAD LTR	CRIMP HEIGHT	WIRE SIZE	WIRE STRIP LENGTH	61743	
A	NOT	USED			
B	.027	26			
C	NOT	USED			
D	NOT	USED			
CRIMP	SIZE	TYPE	FEED	APPL INST	
WIRE	.062	F		A1 8039	
INSUL	.080	O	.450		
WIRE RANGE		INSULATION RANGE		PRESS NO	
26		.040-070		565455-5	
REMARKS: AMP-O-LECTRIC PRE FEED					
REF ID. PLATE: 461264-1					

REMARKS	NO	REV
APPL USED ON MACHINE PART NO	MACH SERIAL NO	DISTRIBUTION
CUSTOMER NAME	APPL SERIAL NO	ORIGINAL
ADDRESS	PURCHASE ORDER	CUSTOMER COPY
CITY	ENG APP	FIELD ENG COPY

SET UP PAGE 10-1	1237	AMP INCORPORATED
DR	APP 3/83	Harrisburg, Pa. 17105
CHK	REL	LOG A D NO 56714-1
C 0150-4754-93	TS 043	REV C
B ECN A-246190	4-90	NAME: MINIATURE QUICK CHANGE APPLICATOR
V A Rev Pre 800 R-5504	1-88	END FEED (RING SPECIAL)