

LOC	DIST	REVISIONS			
CM	00	REV	DATE	BY	APPD
G		REVISED PER ECO-12-007492	03AUG12	KH	SM

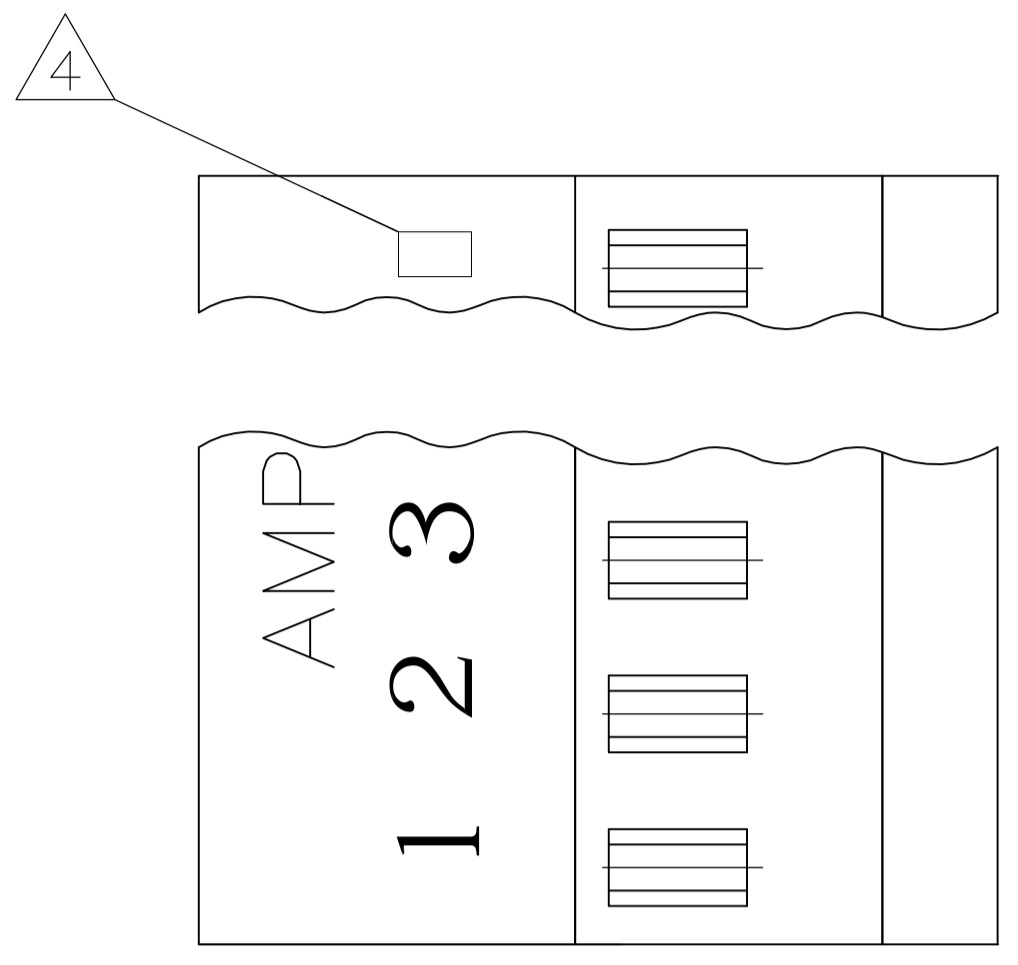

- 1 MATERIAL: CONNECTOR-NYLON UL94V-2.
CONTACTS-0.30 [.012] THICK COPPER ALLOY
BRIGHT TIN-LEAD 0.00203 [.000080] MINIMUM THICK FOR CONTACTS 641534-2 THRU 641534-8,
MATTE WHISKER MITIGATED TIN PLATE 0.00203 [.000080] MINIMUM THICK OVER NICKEL UNDERPLATE FOR CONTACTS 3-641534-2 THRU 3-641534-8.
- 2 CONTACTS ACCEPT 22 AWG WIRE WITH 1.52 [.060] MAXIMUM INSULATION DIAMETER.
- 3 CONTACTS MUST ACCEPT 0.36-0.51 [.014-.020] SQUARE OR ROUND POST AND REMAINED LOCKED IN POSITION.
- 4 IDENTIFICATION NUMBER FOR LAST CIRCUIT MAY NOT APPEAR ON ALL ASSEMBLIES.
- 5 DIMENSIONS IN BRACKETS ARE IN INCHES.
- 6 HOUSING FEATURES ARE: CLOSED END WITH LOCKING RAMP & LED CONTACT.
- 7 OBSOLETE PARTS: OBSOLETE CIS STREAMLINING PER D.RENAUD/D.SINISI
- 8 RED COLOR STRIPE ON HOUSING (NOT SHOWN) MAY RUN DOWN BETWEEN RIBS.

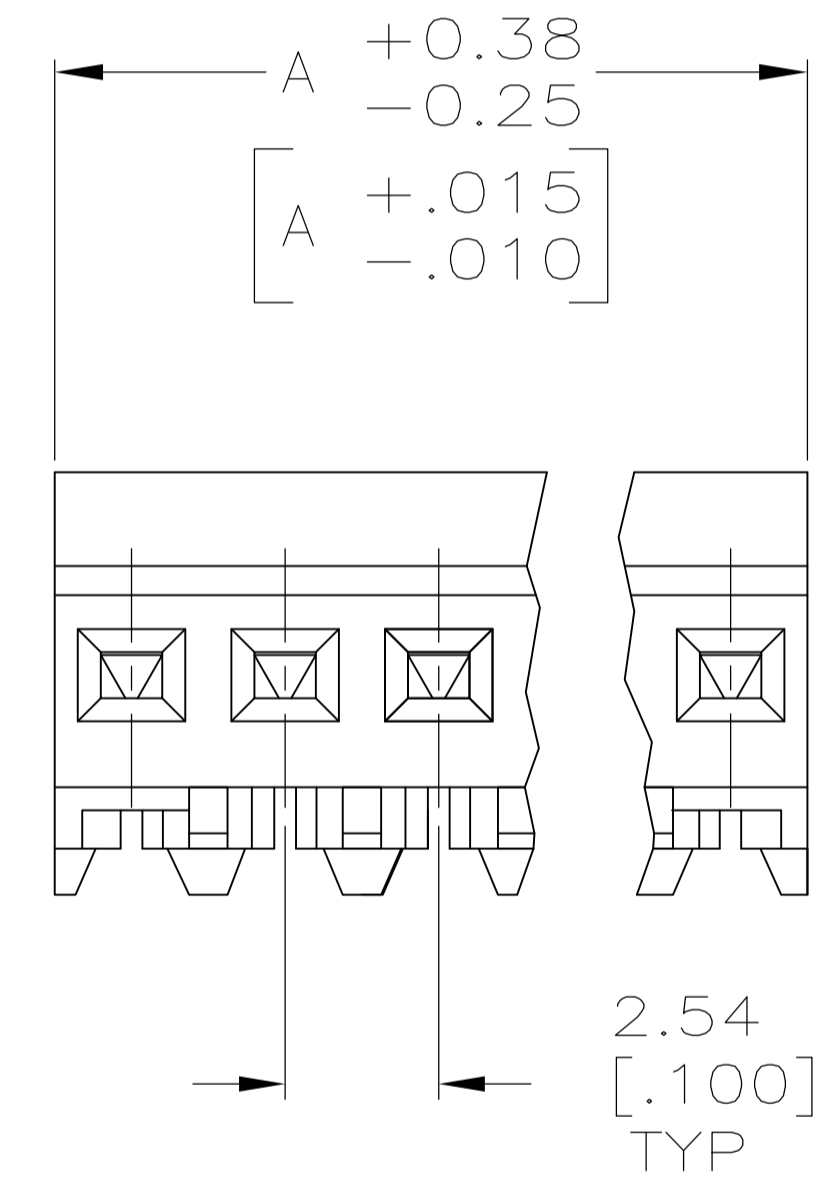
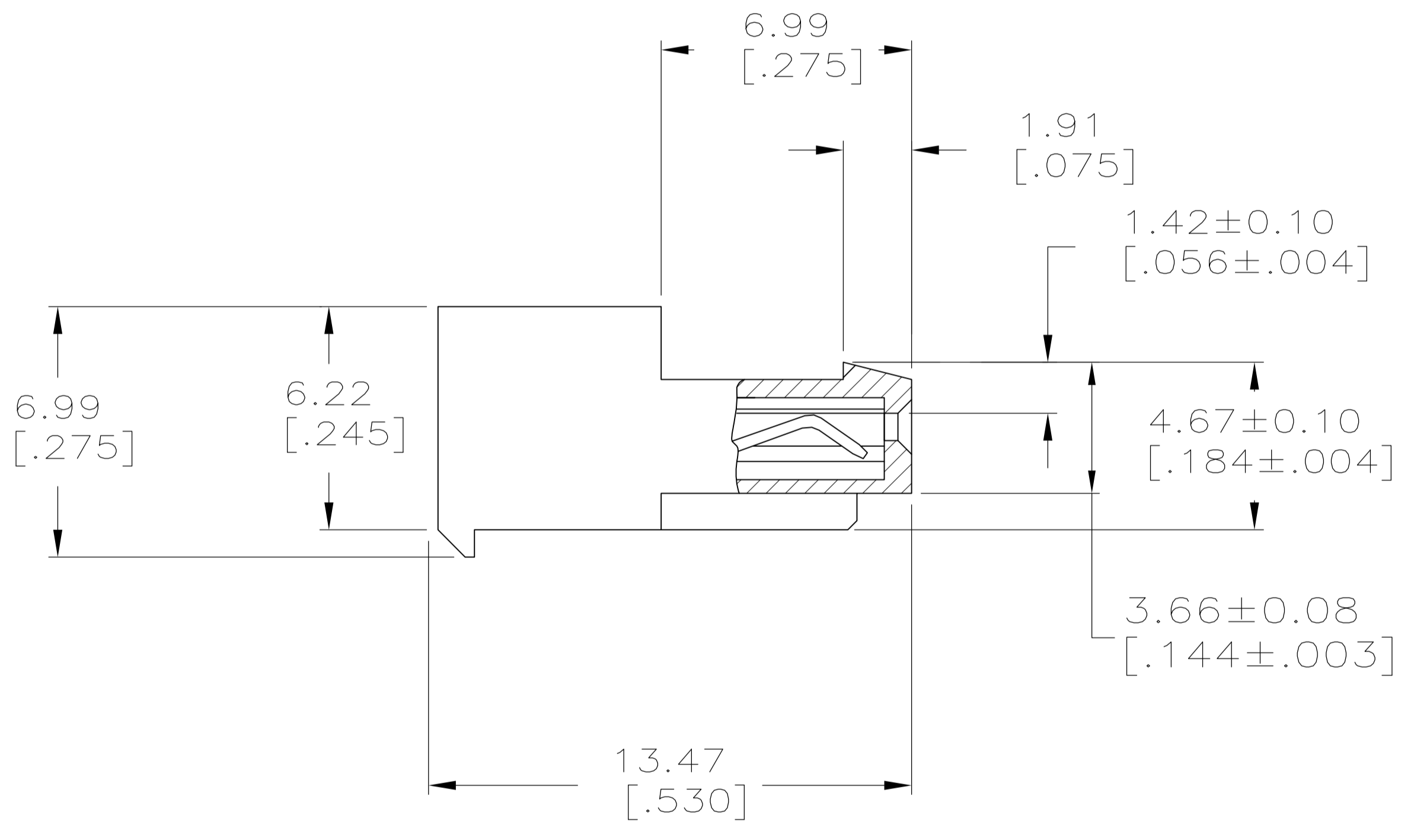

LEAD FREE	DIM A	NO.OF POSN	ASSEMBLY
	20.32 [.800]	8	3-641534-8
	10.16 [.400]	4	3-641534-4
	7.62 [.300]	3	3-641534-3
	5.08 [.200]	2	3-641534-2

CONTAINS LEAD	DIM A	NO.OF POSN	ASSEMBLY
	20.32 [.800]	8	641534-8
	10.16 [.400]	4	641534-4
	7.62 [.300]	3	641534-3
	5.08 [.200]	2	641534-2

7 SUPERSEDED

METRIC

THIS DRAWING IS A CONTROLLED DOCUMENT.

DIMENSIONS: mm [INCHES]	TOLERANCES UNLESS OTHERWISE SPECIFIED:	DIN S. HOOVER 10-DEC-2004	APPROVED D. ROSSI 10-DEC-2004	NAME
0. PLC ±	±			MTA-100 CONNECTOR ASSEMBLY, 22 AWG, FOR .014 TO .020 POST, SPECIAL
1. PLC ±	±			PRODUCT SPEC
2. PLC ±	± 0.13 [.005]			108-1050
3. PLC ±	±			APPLICATION SPEC
4. PLC ±	±			114-1019
ANGLES ±	±			SIZE
MATERIAL	FINISH	WEIGHT	A1 00779	CAGE CODE DRAWING NO
			641534	RESTRICTED TO
				CUSTOMER DRAWING

SCALE 8:1 SHEET 1 OF 1 REV G