

Apr.1.2017 Copyright 2017 HIROSE ELECTRIC CO., LTD. All Rights Reserved.

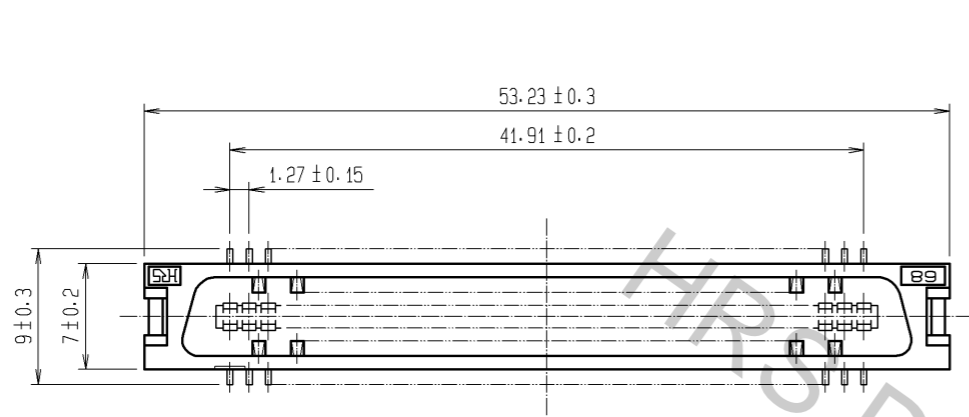

RECOMMENDED LAND PATTERN DIMENSION OF PCB (MOUNTING SIDE)

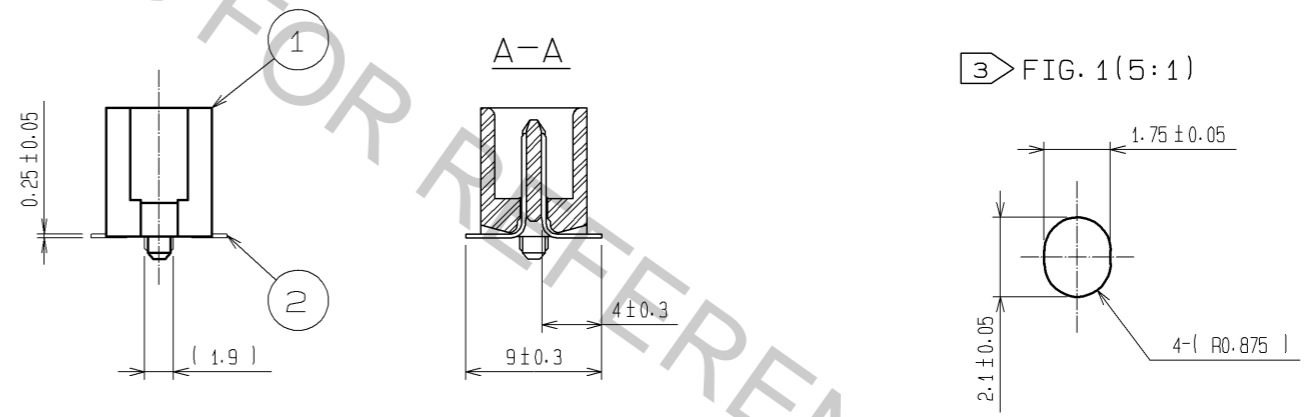
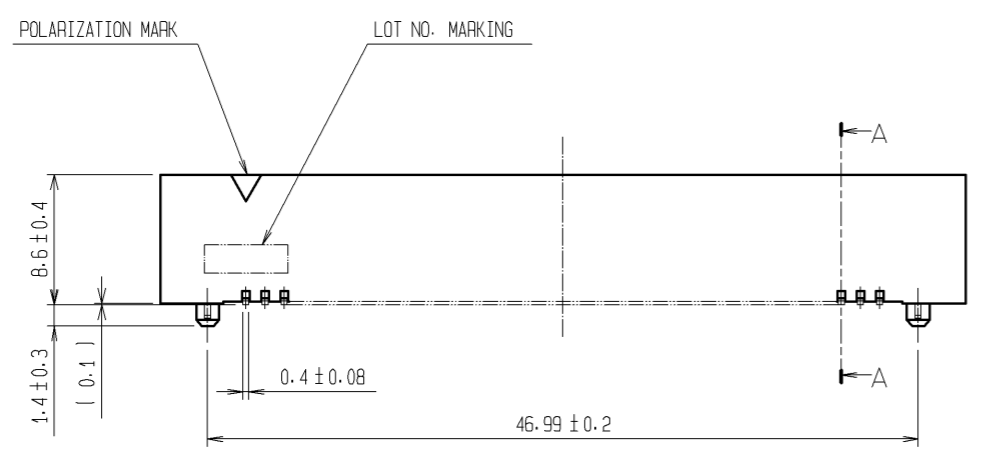
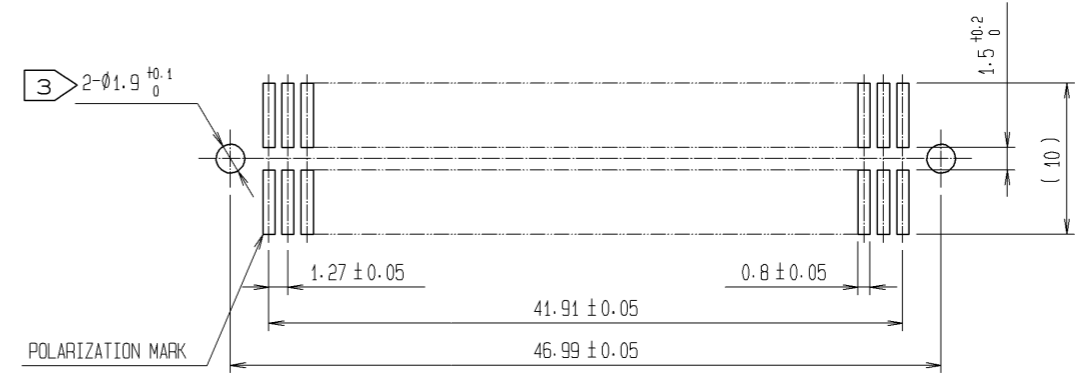

- NOTES 1 LEAD CO-PLANARITY SHALL BE 0.15 MAX.
 2 THE DIMENSIONS IN PARENTHESES ARE FOR REFERENCE.
 3 IN CASE OF THE AUTOMATED MOUNTING, RECOMMENDED HOLE DIAMETER OF BOSS IS SHOWN IN FIG. 1.

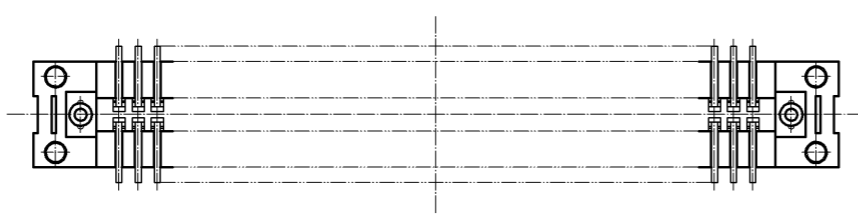

1	PPS	LIGHT BROWN (UL94V-0)	2	PHOSPHOR BRONZE	CONTACT AREA:GOLD 0.2#m min. LEAD AREA:TIN 2#m min. UNDER PLATING:NICKEL 2#m min.		
NO.	MATERIAL	FINISH . REMARKS	NO.	MATERIAL	FINISH . REMARKS		
UNITS mm		SCALE 2 : 1	COUNT 	DESCRIPTION OF REVISIONS	DESIGNED	CHECKED	DATE
HRS HIROSE ELECTRIC CO., LTD.		APPROVED : HS. OKAWA	07. 01. 12	DRAWING NO.	EDC3-082406-21		
		CHECED : HS. OZAWA	07. 01. 12	PART NO.	FX2-68P-1.27SV(71)		
		DESIGNED : KT. DOI	07. 01. 12	CODE NO.	CL572-2006-2-71		
		DRAWN : TS. MIYAKI	07. 01. 12				