

**NOTES:**

**1. MATERIALS:**

CONNECTOR HOUSING: HIGH TEMPERATURE THERMOPLASTIC  
GLASS FILLED, UL94V-0  
COLOR: BLACK

EMI HOUSING: DIE CAST ALLOY, NICKEL PLATED FINISH

TERMINALS: COPPER ALLOY  
COVER: STAINLESS STEEL ALLOY  
EMI GASKET: CONDUCTIVE POLYMER

**2. PLATING:**

CONTACT AREA: 0.764mm MIN. GOLD OVER 2.544mm MIN. NICKEL  
COMPLIANT AREA:

OPTION 1: COMPLIANT AREA: 0.76-1.524mm TIN LEAD (90/10) OVER 1.274mm MIN. NICKEL  
OPTION 2: COMPLIANT AREA: 0.76-1.524mm TIN OVER 1.274mm MIN. NICKEL

**3. PACKAGING SPECIFICATION: TRAY PACK PER PK-76024-001**

**4. MOUNTING HARDWARE: M2x8mm CAP SCREWS (NOT SUPPLIED)**

**5. THIS CONNECTOR IS DESIGNED TO MATE WITH MOLEX CABLE SERIES 111025**

**6. THIS CONNECTOR IS FOR PASSIVE COPPER CABLES ONLY  
NO OPTICAL MODULES OR ACTIVE COPPER CABLES**

ITEM NUMBER	PLATING OPT.
76024-0568	OPTION 1
76024-0569	OPTION 2

<b>CHG NOTE&amp;S SHT2</b> EC NO: UCP2013-2120 DRAWING PRATT 2012/12/13 CHKD:MBANAKIS 2012/12/13 APPR:MBANAKIS 2012/12/18	QUALITY SYMBOLS ▽=0 ▽=0	GENERAL TOLERANCES (UNLESS SPECIFIED) <table border="1"> <thead> <tr> <th></th> <th>mm</th> <th>INCH</th> </tr> </thead> <tbody> <tr> <td>4 PLACES ±</td> <td>---</td> <td>±---</td> </tr> <tr> <td>3 PLACES ±</td> <td>---</td> <td>±---</td> </tr> <tr> <td>2 PLACES ±</td> <td>0.13</td> <td>±---</td> </tr> <tr> <td>1 PLACE ±</td> <td>0.25</td> <td>±---</td> </tr> </tbody> </table>		mm	INCH	4 PLACES ±	---	±---	3 PLACES ±	---	±---	2 PLACES ±	0.13	±---	1 PLACE ±	0.25	±---	DIMENSION STYLE <b>MM ONLY</b>	SCALE <b>2:1</b>	DESIGN UNITS <b>METRIC</b>	THIRD ANGLE PROJECTION
		mm	INCH																		
	4 PLACES ±	---	±---																		
	3 PLACES ±	---	±---																		
2 PLACES ±	0.13	±---																			
1 PLACE ±	0.25	±---																			
		DRAWN BY DATE K.LANG 2008/06/12	CHECKED BY DATE	TITLE <b>IPASS PLUS HSC 84/84 HIGH SPEED CHANNEL 0.8MM I/O</b>																	
		APPROVED BY DATE M.BANAKIS 2008/07/21	MATERIAL NO.	DOCUMENT NO. <b>MOLEX INCORPORATED</b>																	
DRAFT WHERE APPLICABLE MUST REMAIN WITHIN DIMENSIONS		SEE CHART	SIZE C	THIS DRAWING CONTAINS INFORMATION THAT IS PROPRIETARY TO MOLEX INCORPORATED AND SHOULD NOT BE USED WITHOUT WRITTEN PERMISSION	SHEET NO. <b>1 OF 4</b>																

# RECOMMENDED PCB LAYOUT COMPONENT SIDE SHOWN

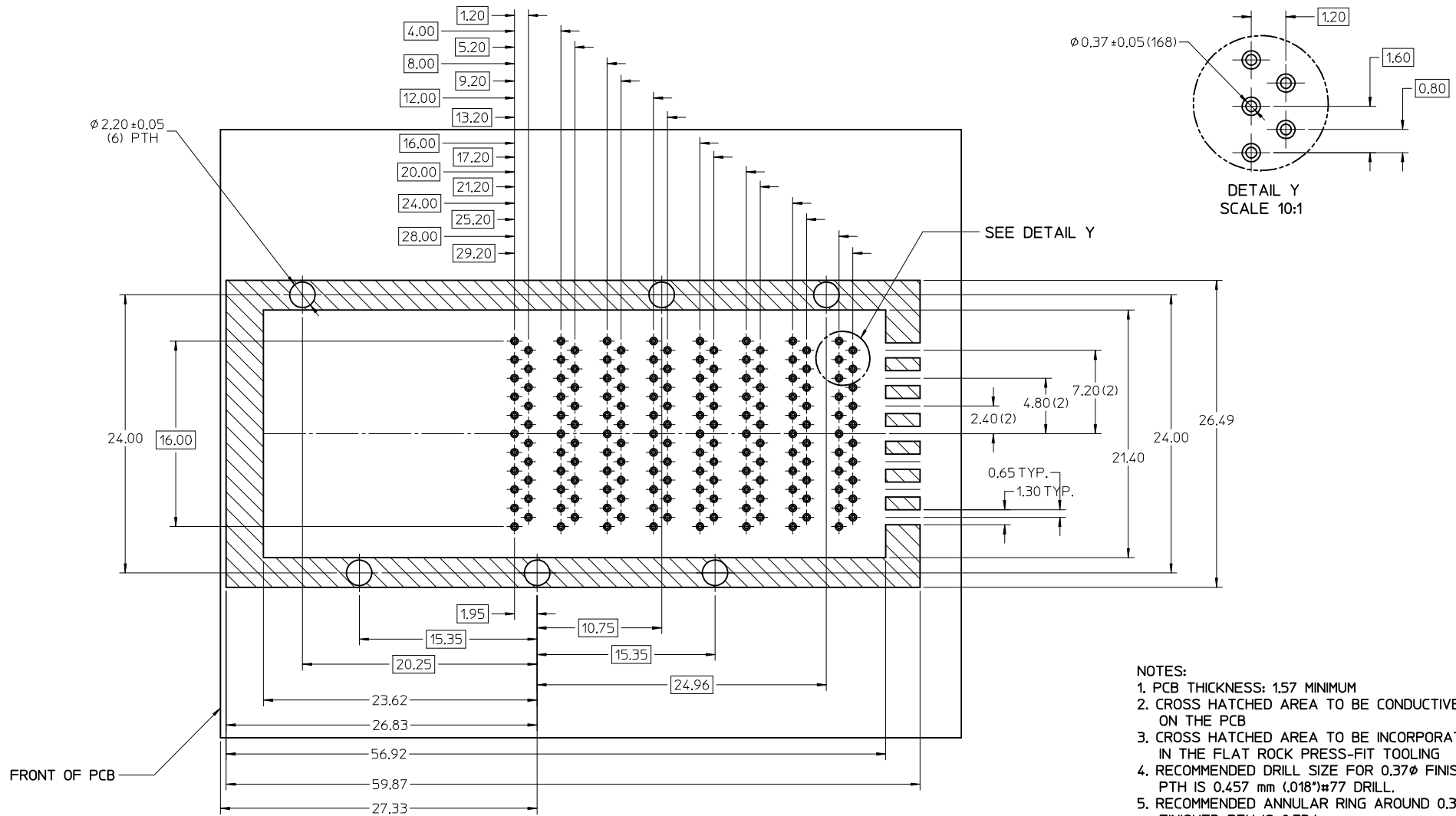

- NOTES:**
1. PCB THICKNESS: 1.57 MINIMUM
  2. CROSS HATCHED AREA TO BE CONDUCTIVE ON THE PCB
  3. CROSS HATCHED AREA TO BE INCORPORATED IN THE FLAT ROCK PRESS-FIT TOOLING
  4. RECOMMENDED DRILL SIZE FOR  $0.37\phi$  FINISHED PTH IS  $0.457$  mm ( $0.018$ "#77 DRILL.
  5. RECOMMENDED ANNULAR RING AROUND  $0.37\phi$  FINISHED PTH IS  $0.73\phi$
  6. MINIMUM RECOMMENDED SPACING: 26.50mm

SEE SHEET 1 EC NO: UCP2013-2120 DRAWING PRATT 2012/12/13 CHKD: MBANAKIS 2012/12/13 APPR: MBANAKIS 2012/12/18	QUALITY SYMBOLS ▽=0 ▽=0	GENERAL TOLERANCES (UNLESS SPECIFIED) <table border="1" style="width: 100%; border-collapse: collapse;"> <thead> <tr> <th></th> <th>mm</th> <th>INCH</th> </tr> </thead> <tbody> <tr> <td>4 PLACES</td> <td>± ---</td> <td>± ---</td> </tr> <tr> <td>3 PLACES</td> <td>± ---</td> <td>± ---</td> </tr> <tr> <td>2 PLACES</td> <td>± 0.13</td> <td>± ---</td> </tr> <tr> <td>1 PLACE</td> <td>± 0.25</td> <td>± ---</td> </tr> </tbody> </table> ANGULAR ±1/2°		mm	INCH	4 PLACES	± ---	± ---	3 PLACES	± ---	± ---	2 PLACES	± 0.13	± ---	1 PLACE	± 0.25	± ---	DIMENSION STYLE <b>MM ONLY</b>	SCALE <b>4:1</b>	DESIGN UNITS METRIC	THIRD ANGLE PROJECTION
				mm	INCH																
4 PLACES	± ---	± ---																			
3 PLACES	± ---	± ---																			
2 PLACES	± 0.13	± ---																			
1 PLACE	± 0.25	± ---																			
DRAWN BY K.LANG		DATE 2008/06/12		TITLE <b>IPASS PLUS HSC 84/84 HIGH SPEED CHANNEL 0.8MM I/O</b>																	
CHECKED BY		DATE		APPROVED BY M.BANAKIS																	
MATERIAL NO.		DATE 2008/07/21		MOLEX INCORPORATED																	
DRAFT WHERE APPLICABLE MUST REMAIN WITHIN DIMENSIONS		SEE SHEET 1		DOCUMENT NO. <b>SD-76024-568</b>																	
SIZE C		THIS DRAWING CONTAINS INFORMATION THAT IS PROPRIETARY TO MOLEX INCORPORATED AND SHOULD NOT BE USED WITHOUT WRITTEN PERMISSION																			

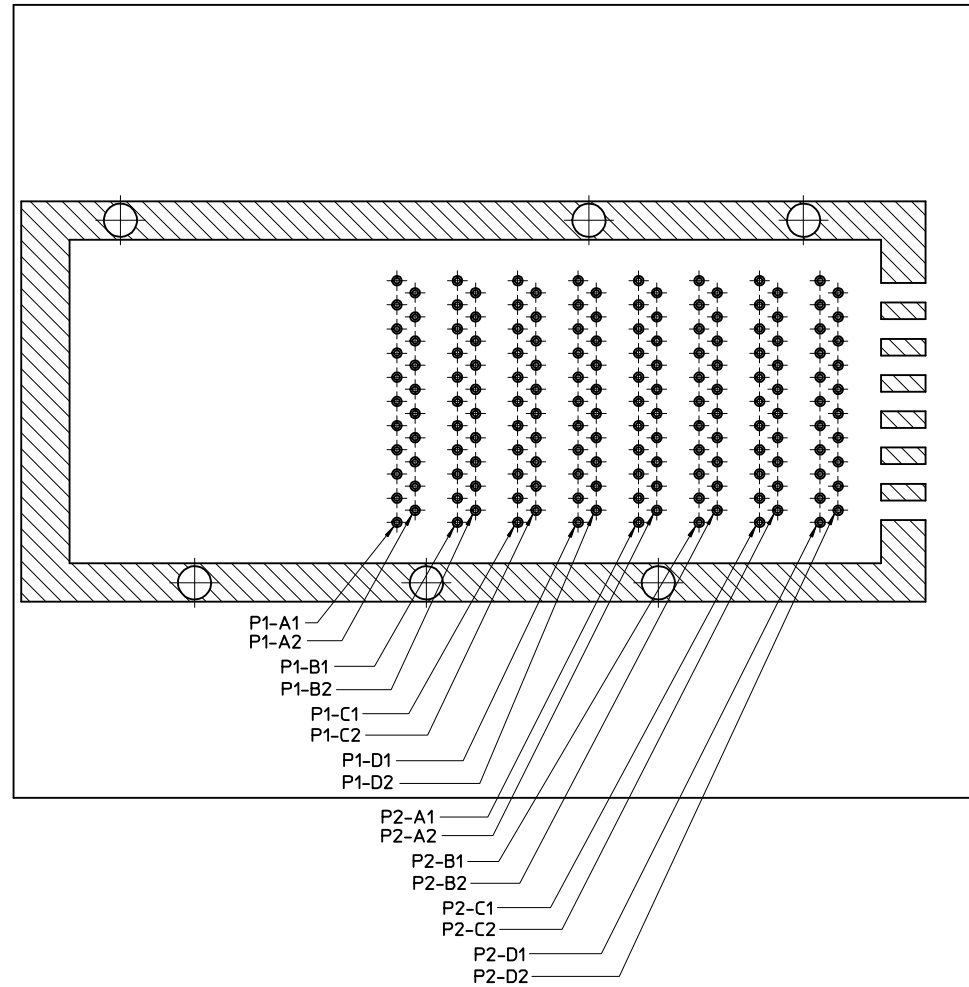
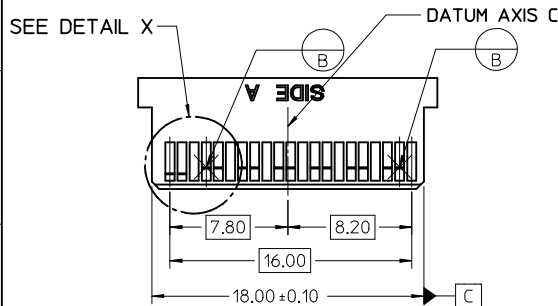
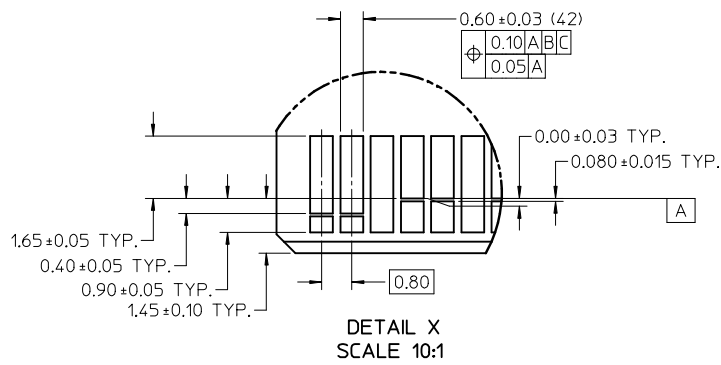
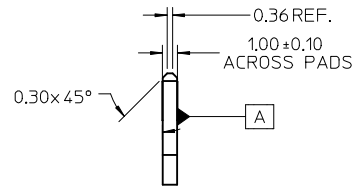
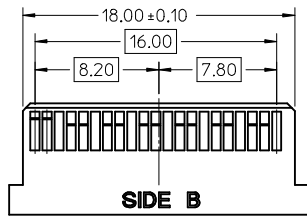

**NOTES:**

- 0.03 MINIMUM KEEPOUT FOR SOLDER MASK AROUND ALL PADS
- DATUM B TARGETS ARE DEFINED BY THE RESPECTIVE PAD CENTER LINES AND THE LEADING EDGE OF THE TARGET PADS

SEE SHEET 1 EC NO: UCP2013-2120 DRAWING PRATT 2012/12/13 CHKD: MBANAKIS 2012/12/13 APPR: MBANAKIS 2012/12/18	QUALITY SYMBOLS ▽=0 ▽=0	GENERAL TOLERANCES (UNLESS SPECIFIED) <table border="1"> <thead> <tr> <th></th> <th>mm</th> <th>INCH</th> </tr> </thead> <tbody> <tr> <td>4 PLACES</td> <td>± ---</td> <td>± ---</td> </tr> <tr> <td>3 PLACES</td> <td>± ---</td> <td>± ---</td> </tr> <tr> <td>2 PLACES</td> <td>± 0.13</td> <td>± ---</td> </tr> <tr> <td>1 PLACE</td> <td>± 0.25</td> <td>± ---</td> </tr> </tbody> </table>		mm	INCH	4 PLACES	± ---	± ---	3 PLACES	± ---	± ---	2 PLACES	± 0.13	± ---	1 PLACE	± 0.25	± ---	DIMENSION STYLE <b>MM ONLY</b>	SCALE <b>4:1</b>	DESIGN UNITS <b>METRIC</b>	THIRD ANGLE PROJECTION
		mm	INCH																		
	4 PLACES	± ---	± ---																		
	3 PLACES	± ---	± ---																		
2 PLACES	± 0.13	± ---																			
1 PLACE	± 0.25	± ---																			
DRAWN BY K. LANG	DATE 2008/06/12	TITLE <b>IPASS PLUS HSC 84/84 HIGH SPEED CHANNEL 0.8MM I/O</b>	<b>MOLEX INCORPORATED</b>																		
CHECKED BY	DATE	APPROVED BY M. BANAKIS	DATE 2008/07/21	MATERIAL NO.	DOCUMENT NO. <b>SD-76024-568</b>	SHEET NO. <b>3 OF 4</b>															
DRAFT WHERE APPLICABLE MUST REMAIN WITHIN DIMENSIONS	SEE CHART	THIS DRAWING CONTAINS INFORMATION THAT IS PROPRIETARY TO MOLEX INCORPORATED AND SHOULD NOT BE USED WITHOUT WRITTEN PERMISSION																			

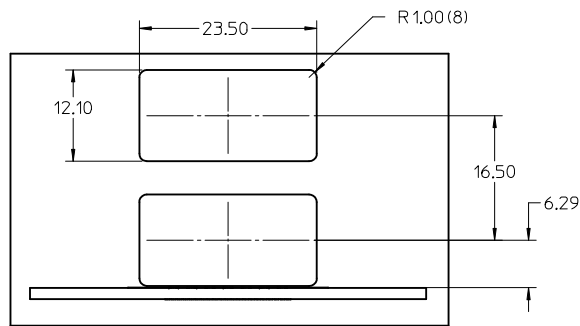
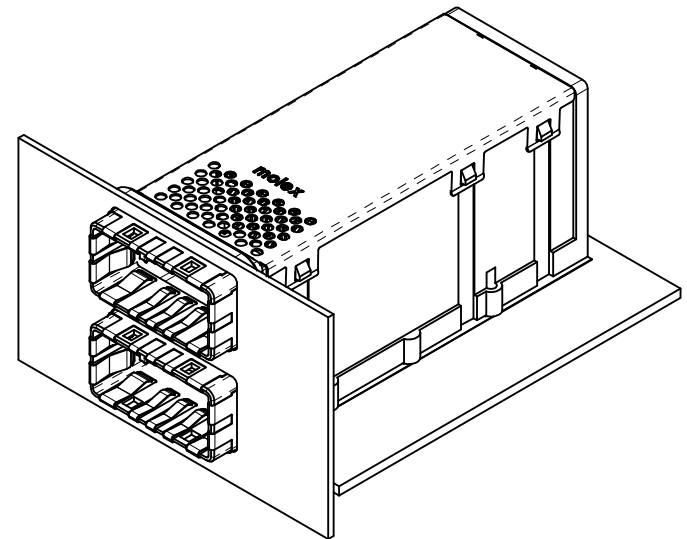

RECOMMENDED PANEL CUT-OUT

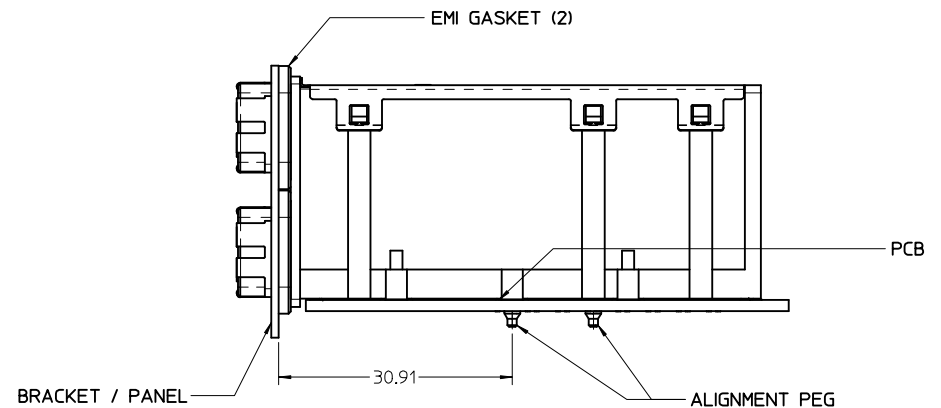

ASSEMBLED VIEW

<b>SEE SHEET 1</b> EC NO: UCP2013-2120 DRAWING PRATT 2012/12/13 CHKD: MBANAKIS 2012/12/13 APPR: MBANAKIS 2012/12/18	QUALITY SYMBOLS ▽=0 ▽=0	GENERAL TOLERANCES (UNLESS SPECIFIED)		DIMENSION STYLE <b>MM ONLY</b>	SCALE <b>2:1</b>	DESIGN UNITS <b>METRIC</b>	THIRD ANGLE PROJECTION	
		4 PLACES ± --- ± ---	3 PLACES ± --- ± ---	DRAWN BY K.LANG	DATE 2008/06/12	TITLE <b>IPASS PLUS HSC 84/84 HIGH SPEED CHANNEL 0.8MM I/O</b>		
		2 PLACES ± 0.13 ± ---	1 PLACE ± 0.25 ± ---	CHECKED BY	DATE	MOLEX INCORPORATED		
		ANGULAR ± 1/2°		APPROVED BY M.BANAKIS	DATE 2008/07/21	MATERIAL NO.	DOCUMENT NO. <b>SD-76024-568</b>	SHEET NO. <b>4 OF 4</b>
DRAFT WHERE APPLICABLE MUST REMAIN WITHIN DIMENSIONS		<b>SEE SHEET 1</b>		THIS DRAWING CONTAINS INFORMATION THAT IS PROPRIETARY TO MOLEX INCORPORATED AND SHOULD NOT BE USED WITHOUT WRITTEN PERMISSION				