

NOTES:

1. MATERIALS AND FINISHES:

BODY - BERYLLIUM COPPER, GOLD PLATED (.000030 MIN.)
 CONTACT - BERYLLIUM COPPER, GOLD PLATED (.000050 MIN.)
 INSULATOR - LIQUID CRYSTAL POLYMER (LCP)

2. ELECTRICAL PERFORMANCE:

FREQUENCY: DC TO 6 GHz
 V.S.W.R. (MATED PAIR): 1.150 MAX. (DC TO 4.0 GHz)
 1.400 MAX. (4.0 TO 6.0 GHz)
 D.W.V.: 500 VRMS MIN.
 INSULATION RESISTANCE: 500 MOHMS MIN.

3. MECHANICAL PERFORMANCE:

THERMAL RESISTANCE: 90 SECONDS MINIMUM @ 450° F
 SOLDERABILITY: 4 CONTACTS MEET MIL-STD-202, METHOD 208
 TERMINAL STRENGTH: PULL-OFF = 13.5 LBS. MIN.
 SHEAR = 9.0 LBS. MIN.

4. PACKAGING: 16 mm TAPE & REEL PACKAGING, 1500 PCS./REEL

908-2210IT		REVISIONS		
DRAWING NO.	REV	DESCRIPTION	DATE	ECO
THIRD ANGLE PROJ.	A	OFFICIAL ENG. RELEASE TO MFG.	5-7-97	41952
				BCG

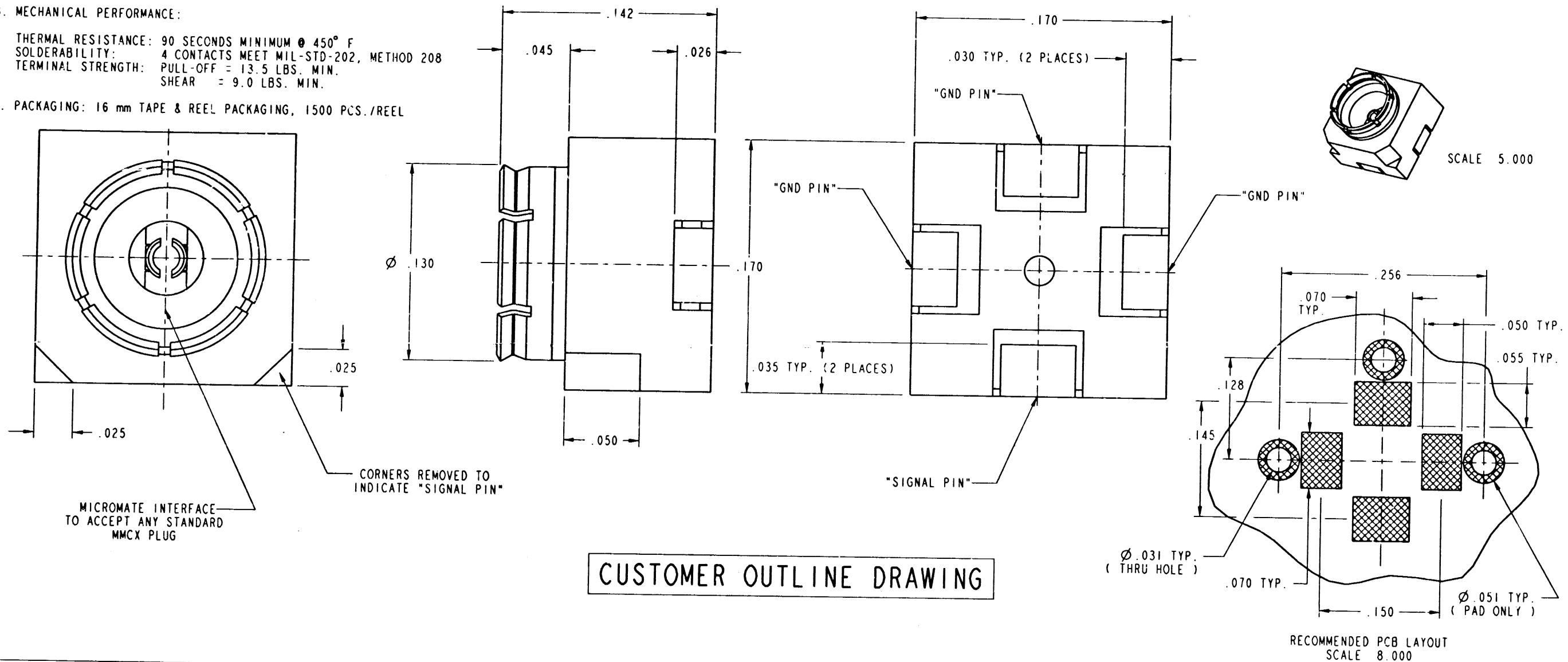

CUSTOMER OUTLINE DRAWING

UNLESS OTHERWISE SPECIFIED, DIMENSIONS ARE IN INCHES AND TOLERANCES ARE:
 2 PLACE DECIMAL ± .015 (0.381 mm)
 3 PLACE DECIMAL ± .005 (0.127 mm)
 ANGLES ± 1°

NOTICE - These drawings, specifications, or other data (1) are, and remain the property of Amphenol Corp. (2) must be returned upon request; and (3) are confidential and not to be disclosed to any person other than those to whom they are given by Amphenol Corp. The furnishing of these drawings, specifications, or other data by Amphenol Corp. or to any other person to anyone for any purpose is not to be regarded by implication or otherwise in any manner licensing, granting rights or permitting such holder or any other person to manufacture, use or sell any product, process or design, patented or otherwise, that may in any way be related to or disclosed by said drawings, specifications, or other data.

MATERIAL	
REFERENCE	EAR 966378-0
GEN#	ASSYFI.MMCX

DRAWN	B. GLEISSNER	DATE	05-05-97
ENGINEER	B. GLEISSNER	DATE	05-05-97
APPROVED		DATE	5-7-97
CAD FILE	I:\MMCX\908-2210IT		

TITLE	MICROMATE FEMALE SURFACE MOUNT (TAPE & REEL)		
CODE ID	74868	DWG SIZE	B
DRAWING NO.	908-2210IT		

Amphenol	
Amphenol Corporation Communication and Network Products Division Danbury, CT U.S.A. 06810	
SCALE: 15:0:1	SHEET 2 OF 3
REV	A