

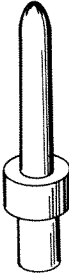

Designers' Choice

MICRO PINS

- Precision engineered and manufactured
- Space saving design for high density packaging
- Micro pins are available in .017 to .080 diameters
- Ideal for mating with our standard line of micro jacks
- Available for press-fit, swage or solder mounting
- Sizes for .032, .062, .093 and .125 thick PC boards
- Custom micro pins manufactured to your specifications
- Other platings available upon request



SPECIFICATIONS

Material: Brass, ASTM-B16

Plating: Gold: .000010 per MIL-G-45204, Type II

Tin: .000200 to .000300 per MIL-T-10727, Type 1

.017 Pin - SWAGE MOUNT

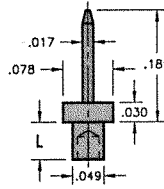

GOLD PLATED CAT. NO.	TIN PLATED "L" Bd CAT. NO.	Lgth.	Thk.
1967-1	1968-1	.051	.032
1967-2	1968-2	.082	.062
1967-3	1968-3	.113	.093
1967-4	1968-4	.145	.125

Mounting Hole
.052 Dia.

.018 Pin - PRESS-FIT

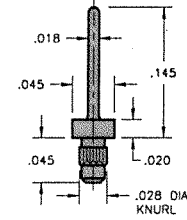

GOLD PLATED CAT. NO.	TIN PLATED CAT. NO.
1986-1	1987-1

Mounting Hole
.026 Dia.

.018 Pin - PRESS-FIT

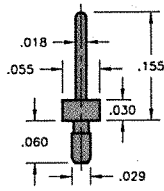

GOLD PLATED CAT. NO.	TIN PLATED CAT. NO.
1988-2	1989-2

Mounting Hole
.026 Dia.

.018 Pin - PRESS-FIT

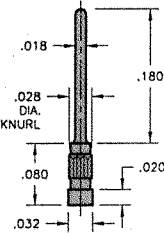

GOLD PLATED CAT. NO.	TIN PLATED CAT. NO.	MATERIAL
1990-2	1991-2	Phos. Bronze

Mounting Hole
.026 Dia.

.018 Pin - PRESS-FIT

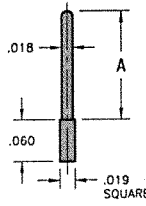

GOLD PLATED CAT. NO.	TIN PLATED "A" Dim. CAT. NO.	Dim.
1992-2	1994-2	.243
1993-2	1995-2	.140

Mounting Hole
.022 Dia.

.020 Pin - PRESS-FIT

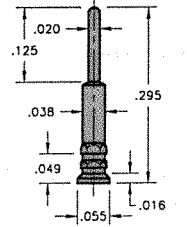

GOLD PLATED CAT. NO.	TIN PLATED CAT. NO.
1996-2	1997-2

Mounting Hole
.040 Dia.

.020 Pin - SOLDER MOUNT

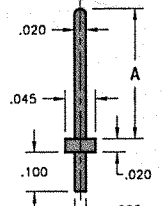

GOLD PLATED CAT. NO.	TIN PLATED "A" Dim. CAT. NO.	Dim.
1998-3	2000-3	.250
1999-3	2001-3	.425

Mounting Hole
.024 Dia.

.025 Pin - SWAGE MOUNT

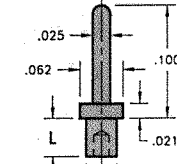

GOLD PLATED CAT. NO.	TIN PLATED "L" Bd CAT. NO.	Lgth.	Thk.
1404-1	1424-1	.051	.032
1404-2	1424-2	.082	.062
1404-3	1424-3	.113	.093
1404-4	1424-4	.145	.125

Mounting Hole
.052 Dia.

.025 Pin - SWAGE MOUNT

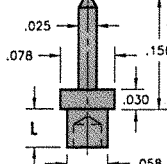

GOLD PLATED CAT. NO.	TIN PLATED "L" Bd CAT. NO.	Lgth.	Thk.
1408-1	1428-1	.062	.032
1408-2	1428-2	.094	.062
1408-3	1428-3	.125	.093
1408-4	1428-4	.156	.125

Mounting Hole
.062 Dia.

.025 Pin - SWAGE MOUNT

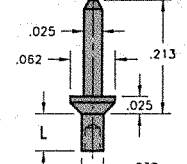

GOLD PLATED CAT. NO.	TIN PLATED "L" Bd CAT. NO.	Lgth.	Thk.
1406-1	1426-1	.047	.032
1406-2	1426-2	.078	.062
1406-3	1426-3	.110	.093
1406-4	1426-4	.141	.125

Mounting Hole
.035 Dia.

.025 Pin - SWAGE MOUNT

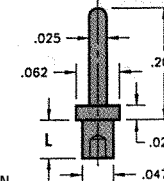

GOLD PLATED CAT. NO.	TIN PLATED "L" Bd CAT. NO.	Lgth.	Thk.
1407-1	1427-1	.051	.032
1407-2	1427-2	.082	.062
1407-3	1427-3	.113	.093
1407-4	1427-4	.145	.125

Mounting Hole
.052 Dia.

.025 Pin - SWAGE MOUNT

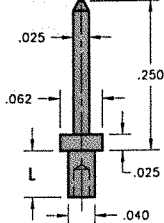

GOLD PLATED CAT. NO.	TIN PLATED "L" Bd CAT. NO.	Lgth.	Thk.
1401-1	1421-1	.065	.032

Mounting Hole
.043 Dia.

.040 Pin - SWAGE MOUNT

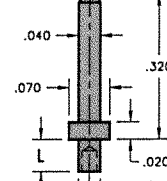

GOLD PLATED CAT. NO.	TIN PLATED "L" Bd CAT. NO.	Lgth.	Thk.
1405-1	1425-1	.051	.032
1405-2	1425-2	.082	.062
1405-3	1425-3	.113	.093

Mounting Hole
.043 Dia.

.040 Pin - SWAGE MOUNT

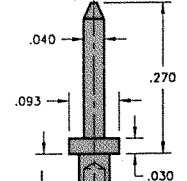

GOLD PLATED CAT. NO.	TIN PLATED "L" Bd CAT. NO.	Lgth.	Thk.
1402-3	1422-3	.125	.093

Mounting Hole
.062 Dia.

.040 Pin - PRESS-FIT

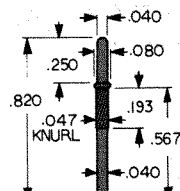

KAY PIN

Press-fit into .043 dia. hole

CAT. NO. 1218 MATERIAL: Solid Nickel Silver

.040 Pin - SWAGE MOUNT

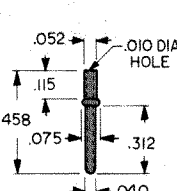

TUBULAR HOLLOW PIN

Stake to .062 board. Mounting hole .059 dia.

CAT. NO. 1219 MATERIAL: Brass, Tin Plate

.080 Pin - SWAGE MOUNT

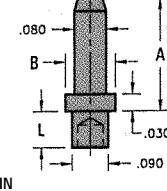

GOLD PLATED CAT. NO.	TIN PLATED "A" Dim. CAT. NO.	"B" Dim.	"L" Dim.	Bd Thk.
1447-1	1455-1	.335	.156	.051
1447-2	1455-2	.400	.125	.094
1447-3	1455-3	.400	.125	.125
1447-4	1455-4	.400	.125	.156

Mounting Hole
.094 Dia.

.040 Pins - INSULATED SHORTING PLUG

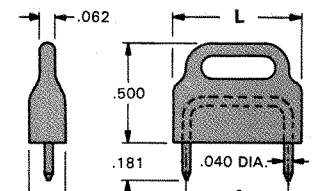

RED PLATED CAT. NO.	BLACK PLATED CAT. NO.	"A" Dim.	"L" Dim.
1460R	1460B	.200	.375
1461R	1461B	.250	.375
1462R	1462B	.400	.620
1463R	1463B	.500	.620

INSULATOR: Plastic, Red or Black
PINS: Brass, Gold Plate