

Test accessories - EV-T2MBIE24-1ACDC-INFRA - 1410506

Please be informed that the data shown in this PDF Document is generated from our Online Catalog. Please find the complete data in the user's documentation. Our General Terms of Use for Downloads are valid (<http://phoenixcontact.com/download>)



Special Vehicle Inlet for charging station tests, CCS type 2, IEC 62196-3, 125 A / 850 V (DC), 24 V Locking actuator, Single wires, Length: 2 m

Product Description

Special Vehicle Inlet for charging station tests, solely for laboratory tests, tests with charging stations (EVSE), and further analyses on the infrastructure side - not for installation in any type of vehicle, cannot be used outside of the laboratory area



Key Commercial Data

| | |
|--------------------------------------|----------|
| Packing unit | 1 pc |
| Weight per Piece (excluding packing) | 4580.0 g |
| Custom tariff number | 85366990 |
| Country of origin | Germany |

Technical data

Dimensions

| | |
|------------------|--------|
| Conductor length | 2.00 m |
|------------------|--------|

General

| | |
|-----------------------|--------------------------------------------------|
| Product type | Special Vehicle Inlet for charging station tests |
| Standards/regulations | IEC 62196-3 |
| Charging standard | CCS type 2 |
| Charging mode | Mode 2, 3, 4 |

Features

| | |
|----------------------------------|----------|
| Charging power | 106 kVA |
| Number of phases | 1 |
| Rated current for power contacts | 125 A DC |
| | 20 A AC |
| Rated voltage for power contacts | 250 V AC |

Test accessories - EV-T2MBIE24-1ACDC-INFRA - 1410506

Technical data

Features

| | |
|---------------------------------------------|--------------------------|
| | 850 V DC |
| Rated current for signal contacts | 2 A |
| Rated voltage for signal contacts | 30 V AC |
| Type of signal transmission | Pulse width modulation |
| Temperature monitoring | 2x Pt 1000 |
| Number of power contacts | 5 (L1, N, PE, DC+, DC-) |
| Number of signal contacts | 2 (CP, PP) |
| Insertion force | < 100 N |
| Withdrawal force | < 100 N |
| Insertion/withdrawal cycles | > 10000 |
| Ambient temperature (operation) | -30 °C ... 50 °C |
| Ambient temperature (storage/transport) | -40 °C ... 80 °C |
| Altitude difference for area of application | 5000 m (above sea level) |
| Degree of protection | IP44 (plugged in) |
| | IP55 (in road position) |

Locking actuator

| | |
|------------------------------------------|---------------------|
| Typical power supply at the motor | 24 V |
| Possible power supply range at the motor | 22 V ... 26 V |
| Typical motor current for locking | 0.05 A |
| Max. reverse current of the motor | 0.5 A |
| Max. dwell time with reverse current | 1000 ms |
| Recommended adaptation time | 600 ms |
| Maximum voltage for locking detection | 30 V |
| Service life | > 10000 load cycles |
| Ambient temperature (operation) | -30 °C ... 50 °C |
| Length of cable | 0.5 m |

Classifications

eCl@ss

| | |
|------------|----------|
| eCl@ss 4.1 | 27260701 |
| eCl@ss 5.1 | 27059110 |
| eCl@ss 6.0 | 27059290 |
| eCl@ss 8.0 | 27440590 |
| eCl@ss 9.0 | 27144706 |

Test accessories - EV-T2MBIE24-1ACDC-INFRA - 1410506

Classifications

ETIM

| | |
|----------|----------|
| ETIM 4.0 | EC002498 |
| ETIM 5.0 | EC002498 |

Drawings

Connection diagram

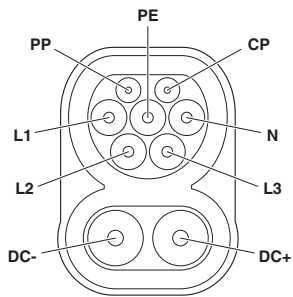

Pin assignment of Vehicle Inlet

Dimensional drawing

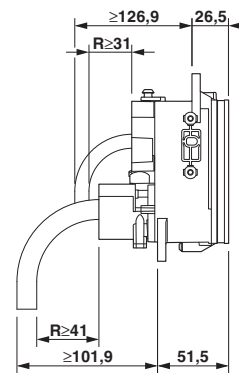

Dimensional drawing, side view

Dimensional drawing

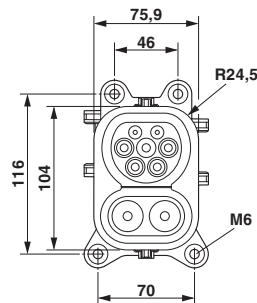

Dimensional drawing top view

Test accessories - EV-T2MBIE24-1ACDC-INFRA - 1410506

Schematic diagram

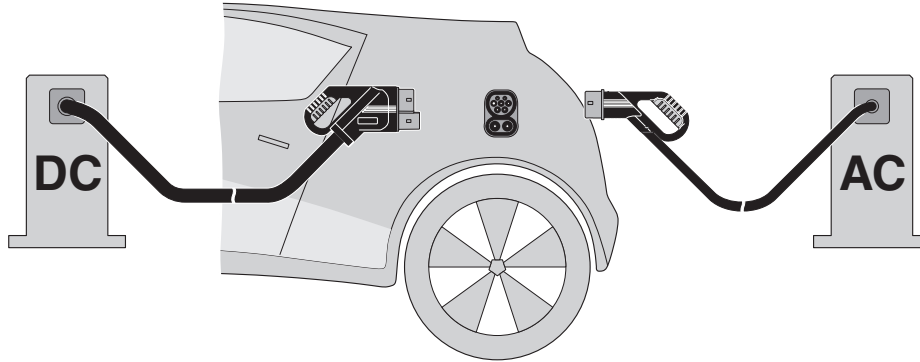

The Combined Charging System (CCS) principle - standard-compliant charging system for electric vehicles, which supports both conventional AC charging and fast DC charging. Both Vehicle Connectors fit into the CCS Vehicle Inlet.

Test accessories - EV-T2MBIE24-1ACDC-INFRA - 1410506

Schematic diagram

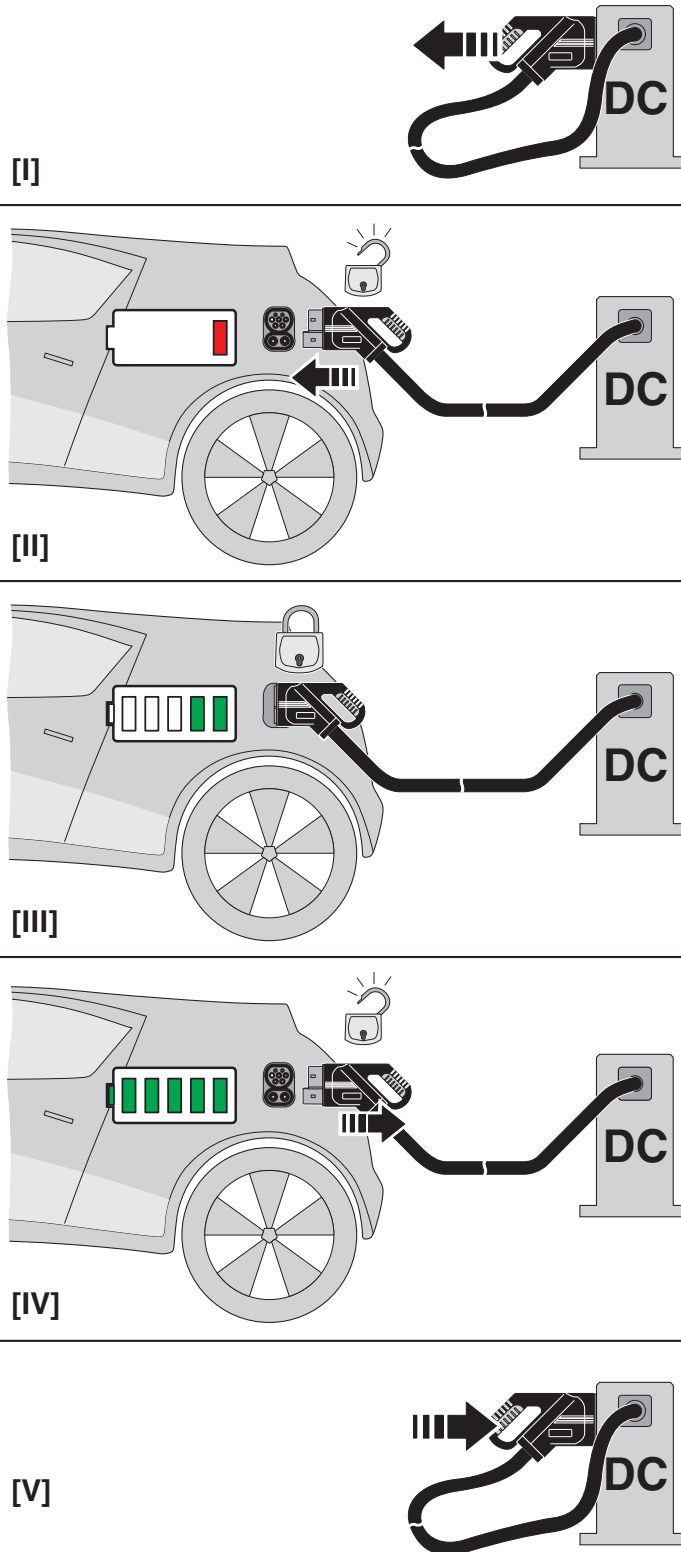

Test accessories - EV-T2MBIE24-1ACDC-INFRA - 1410506

Schematic diagram

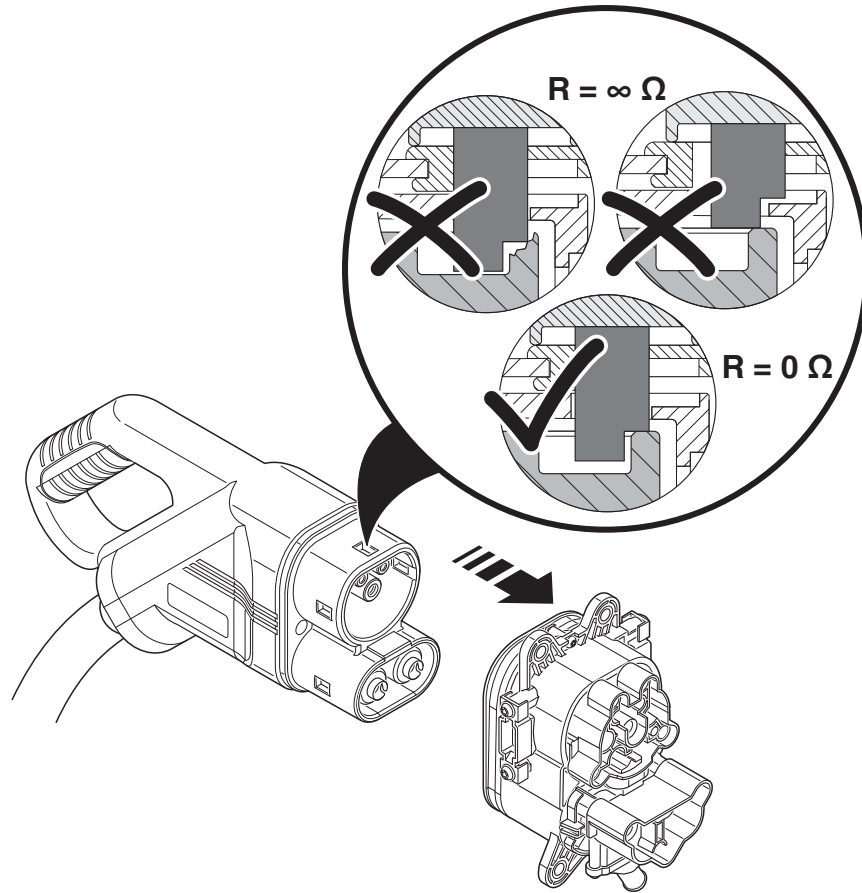

Detection for Vehicle Connector