

|     |      |           |     |               |         |     |      |
|-----|------|-----------|-----|---------------|---------|-----|------|
| LOC | DIST | REVISIONS |     |               |         |     |      |
| CM  | 00   | P         | LTR | DESCRIPTION   | DATE    | DWN | APVD |
|     |      | D         |     | ECO-07-007620 | 11APR07 | KW  | DB   |

1. DIMENSION IN BRACKETS ARE IN INCHES.

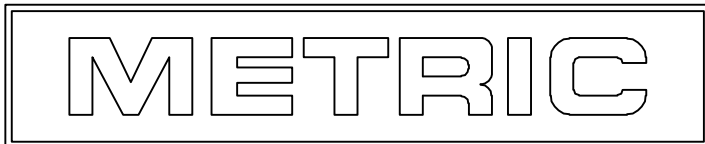
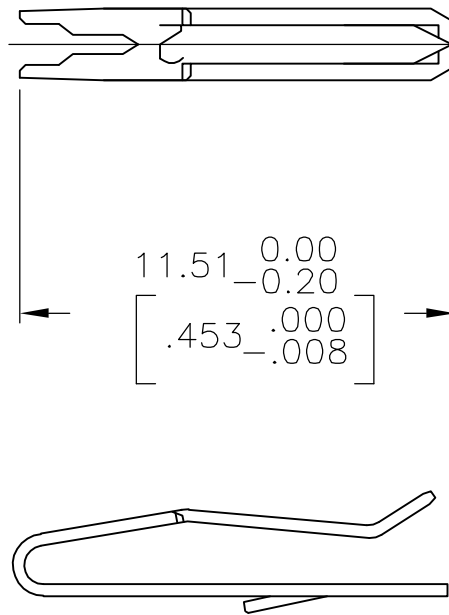

|          |          |
|----------|----------|
| TIN      | 641643-2 |
| TIN-LEAD | 641643-1 |
| FINISH   | PART NO  |

RELEASED FOR PUBLICATION

ALL RIGHTS RESERVED.

BY TYCO ELECTRONICS CORPORATION.

© COPYRIGHT

THIS DRAWING IS UNPUBLISHED.

|  |                             |   |  |  |               |
|--|-----------------------------|---|--|--|---------------|
| DIMENSIONS:<br>mm [INCHES]             | DWN<br>L.SMITH<br>20JAN94   | MATERIAL<br>0.30[.012] THK COPPER ALLOY                   | FINISH<br>MATTE TIN OR BRIGHT TIN LEAD<br>0.00203[.000080] MIN THK |  |               |
|  | CHK<br>R.SWING<br>20JAN94   | Tyco Electronics Corporation<br>Harrisburg, PA 17105-3608 |  |  |               |
| TOLERANCES UNLESS OTHERWISE SPECIFIED: | APVD<br>E.BEILES<br>27JAN94 |   |  | NAME<br>CONTACT,0.36-0.51[.014-.020] POST<br>LOOSE PIECE 22 AWG WIRE,MTA-100 |               |
| 0 PLC ± -                              | PRODUCT SPEC                | SIZE  | CAGE CODE  | DRAWING NO   | RESTRICTED TO |
| 1 PLC ± -                              | APPLICATION SPEC            | A4  | 00779  | C-641643   | -             |
| 2 PLC ± -                              | WEIGHT                      | CUSTOMER DRAWING  |  |  | SCALE 5:1     |
| 3 PLC ± -                              |                             |   |  |  | SHEET 1 OF 1  |
| 4 PLC ± -                              |                             |   |  |  | REV D         |
| ANGLES ± -                             |                             |   |  |  |               |

