

a) Part as supplied

202D9XX-X-G90

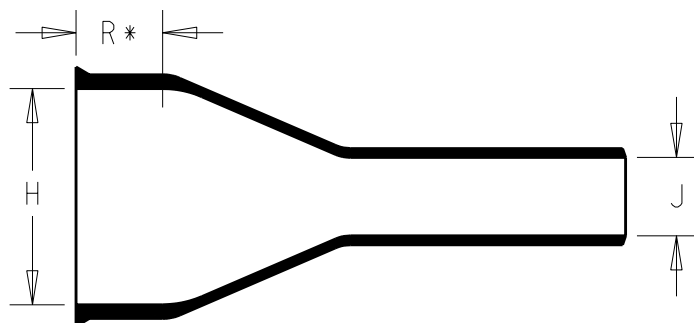

R* SEE NOTE (2)

b) Part after unrestricted recovery

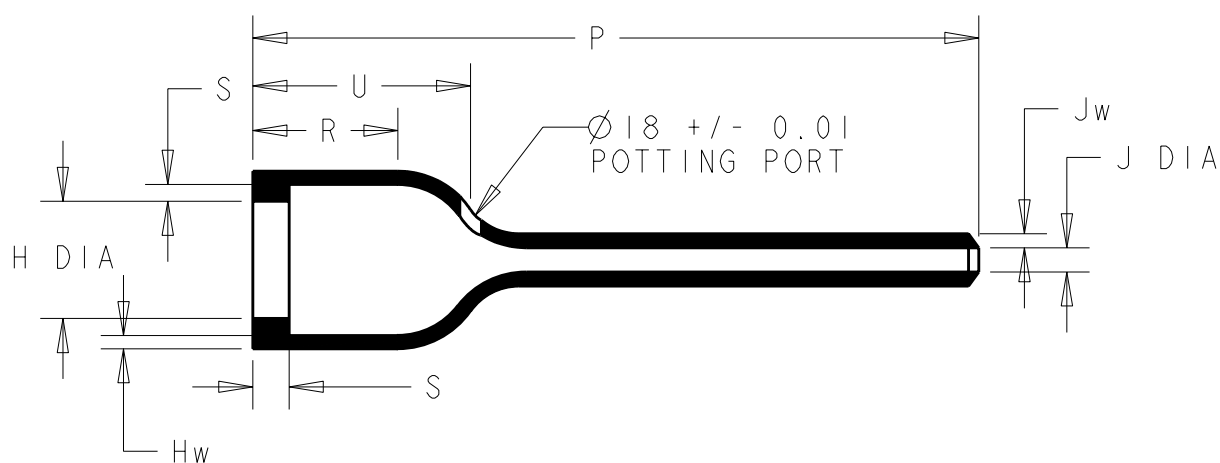

DIMENSIONS in millimetres
(in inches, for reference)

| Part No. | H | | J | | P | R | S | T | JO | HW | JW | U |
|---------------|----------------|----------------|----------------|---------------|----------------|----------------|----------------|-----------------|----------------|----------------|----------------|----------------|
| | Min | Max | Min | Max | ±10% | ±10% | ±10% | ±10% | REF | ±20% | ±20% | ±10% |
| | a | b | a | b | b | b | b | b | b | b | b | b |
| 202D921-X-G90 | 19.3 {0.75} | 13.0 {0.51} | 6.3 {0.24} | 2.1 {0.08} | 60.2 {2.37} | 11.7 {0.46} | 3.05 {0.12} | 1.02 {0.04} | 37.6 {1.48} | 1.52 {0.06} | 1.14 {0.04} | 15.7 {0.62} |
| 202D932-X-G90 | 26.1 {1.03} | 19.1 {0.75} | 7.6 {0.3} | 2.6 {0.10} | 74.2 {2.92} | 12.2 {0.48} | 3.05 {0.12} | 1.02 {0.04} | 1.77 {0.07} | 1.78 {0.07} | 1.14 {0.04} | 20.3 {0.80} |
| 202D953-X-G90 | 34.2 {1.35} | 26.0 {1.02} | 9.6 {0.38} | 3.0 {0.12} | 84.3 {3.32} | 12.2 {0.48} | 3.05 {0.12} | 1.02 {0.04} | 51.1 {2.01} | 1.78 {0.07} | 1.14 {0.04} | 20.9 {0.90} |
| 202D963-X-G90 | 43.6 {1.72} | 34.1 {1.34} | 11.4 {0.45} | 3.6 {0.14} | 99.6 {3.92} | 12.2 {0.48} | 3.05 {0.12} | 1.65 {0.064} | 57.7 {2.27} | 1.78 {0.07} | 1.14 {0.04} | 26.2 {1.03} |

Copyright(!)

The copyright in this drawing is the property of Tyco Electronics UK Ltd. The drawing is issued on the condition that it is not copied, reproduced or disclosed to a third party, either in whole or in part without the prior written consent of Tyco Electronics UK Ltd.

Drawn P.Davies Checked

Issue 1

Date September 2009

Conforms to ISO Recommendations

For approval see PDM System

3rd Angle Projection

Not to Scale

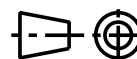

| Iss. | Date | E.C.R / R.T.S. No. | Details of Change |
|------|------------|--------------------|---|
| 1 | Sept. 2009 | 181376.1 | RE-DRAW TO INCORPORATE EUROPEAN EXPANSION METHOD. |

Ordering Information

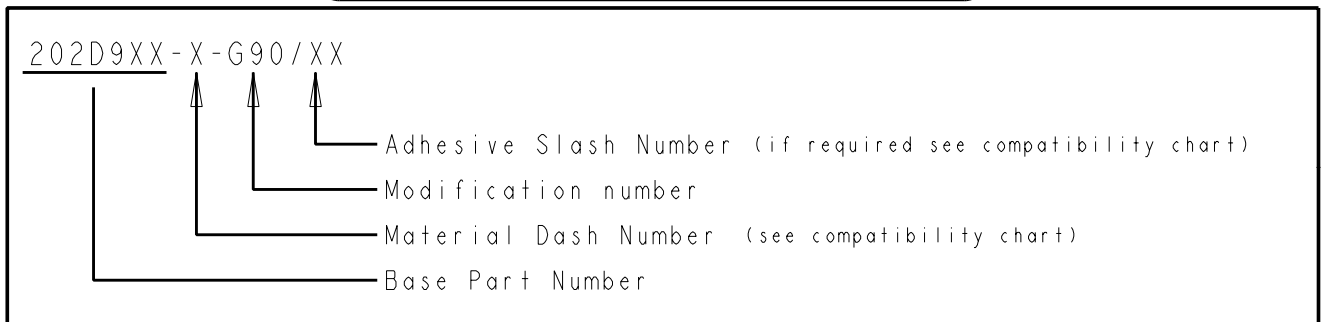

COMPATIBILITY CHART

| Material Dash Number | Material Description | SPEC Number | Coating Slash Number |
|----------------------|----------------------------|-------------|----------------------|
| -3 | POLYOLEFIN, SEMI-RIGID | RT-301 | /42, /86, /180 |
| -4 | POLYOLEFIN, FLEXIBLE | RT-1304 | /42, /86, /180 |
| -25 | ELASTOMER, FLUID RESISTANT | RK-6713 | /42, /86, /225 |
| -100 | ZERO HALOGEN | RW-2008 | /86, /180 |
| | | | |
| | | | |
| | | | |

NOTES

- ① As supplied dimensions are for uncoated parts, when coating is added entry diameters will reduce by 1.5mm Max.
- ② R* dimension a) part as supplied 12 mm +/- 10%

| | |
|---|--|
| <p>Tyco Electronics UK Ltd. Faraday Road, Swindon, Wiltshire, SN3 5HH England Telephone: (01793) 528171 Fax: 572516</p> | <p>Tyco Electronics Corporation 300, Constitution Drive, Menlo Park, CA 94025 USA Telephone (650) 361-3860 Fax: (650) 361-5579</p> |
| Cage Code K1010 | Cage Code 06090 |