

1	2	3	4	5	6	7	8
PRODUCT NUMBER	TAIL PLATING OPTION, SEE NOTE 2	IXI EXTERNAL ASSEMBLY WITH WINDOW	IXI HEAT SINK MOUNTING CLIP	HEAT SINK			
10112629-101	OPTION 1	10112626-103	10112656-003LF	10112655-001LF			
10112629-101LF	OPTION 2	10112626-103LF					

NOTES:

- MATERIALS:
CONNECTOR HOUSING: HIGH TEMPERATURE THERMOPLASTIC
GLASS FILLED, UL 94V-0
EMI CAGE: NICKEL SILVER ALLOY
EMI FINGERS: COPPER ALLOY
TERMINALS: COPPER ALLOY
HEAT SINK CLIP: STAINLESS STEEL
HEAT SINK: ALUMINIUM ALLOY
- FINISHES:
EMI FINGERS: 0.50um MIN NICKEL
CONTACT AREA: 0.76um MIN GOLD OVER 2.54um MIN NICKEL TAIL AREA:
OPTION 1: 0.76um - 1.52um TIN/LEAD (90/10) OVER 2.54um MIN NICKEL
OPTION 2: 0.76um - 1.52um TIN (LEAD FREE) OVER 2.54um MIN NICKEL
- PRODUCT SPECIFICATION: GS-12-651.
- PRODUCT PACKING SPECIFICATION: GS-14-1490.
EXTERNAL ASSEMBLY WITH WINDOWS WILL BE IN ONE BOX.
HEAT SINK AND HEAT SINK MOUNTING CLIP WILL BE IN EACH ONE BOX.
TOTAL THREE BOXES WILL BE IN A MASTER CARTON.
- APPLICATION SPECIFICATION: GS-20-0327.
- MOUNTING HARDWARE: M2X0.4 BUTTON HEAD SCREW
MOUNTING SCREW LENGTH: BOARD THICKNESS + 1.4mm MAX (0.9mm MIN).
1 REQUIRED PER ASSEMBLY.
MOUNTING HARDWARE NOT SUPPLIED.
- THIS CONNECTOR IS DESIGNED TO MEET THE REQUIREMENTS OF INDUSTRY SPECIFICATION SFF-8644.
- HEAT SINK AND HEAT SINK MOUNTING CLIP FINAL ASSEMBLY AFTER EXTERNAL ASSEMBLY WITH WINDOW APPLIED TO PCB.

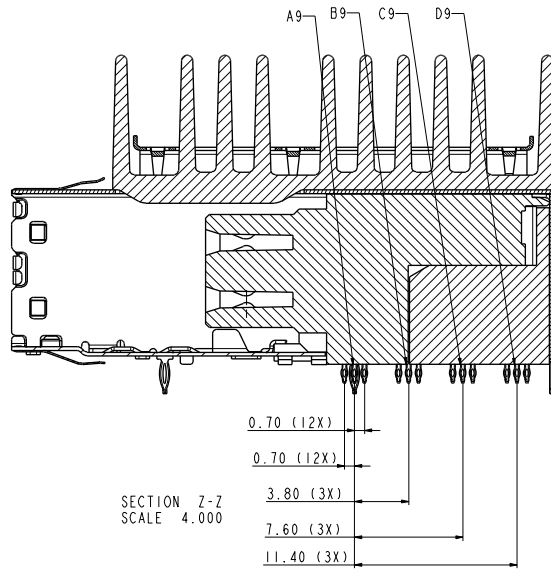
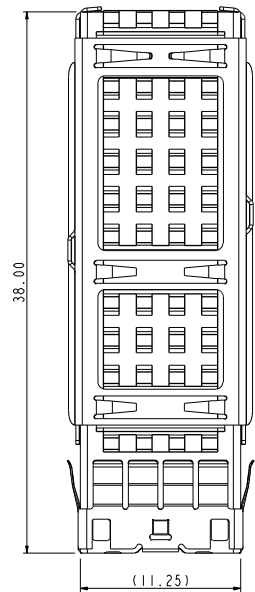

MATES WITH MINI-SAS HD ENDS IN:
10112041 SERIES (4X)
10117771 SERIES (4X)
10117946 SERIES (4X)
10117949 SERIES (4X)

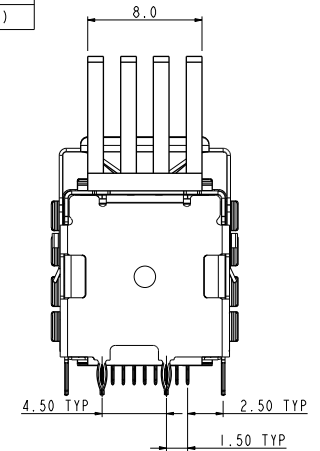
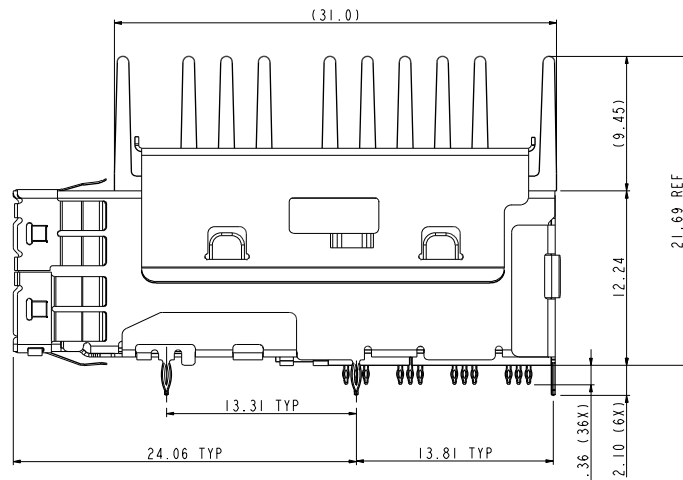
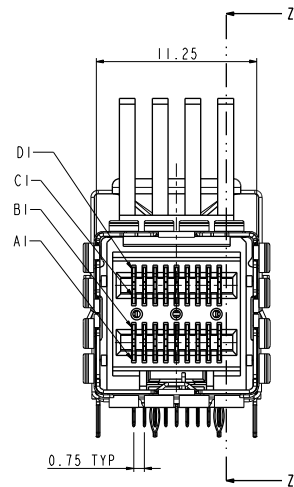

Copyright FCI

spec ref	-	dr	Benny Chen	2012-05-07	projection	MM	size	A2	scale	4.000
tolerance std	ISO 406 ISO 1101	eng	De-Feng Qin	2013-03-01			ecn no	rel level		
TOLERANCES UNLESS OTHERWISE SPECIFIED		chr	Jon Qin	2013-03-01					product family	MINI-SAS HD
surface	linear	0.X	±0.50		title Ixi EXTERNAL ASSEMBLY WITH HEAT SINK MINI-SAS HD	dwg no 10112629	rev A			
		0.XX	±0.30							
	angular	0°	±3°							
ISO 1302				www.fcicom	cat. no.	-	Product - Customer Drw	sheet 1 of 6		

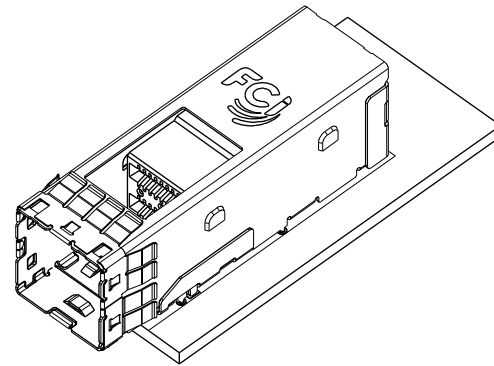

EXTERNAL ASSEMBLY WITH WINDOW APPLIED TO PCB
10112626-103 & 103LF

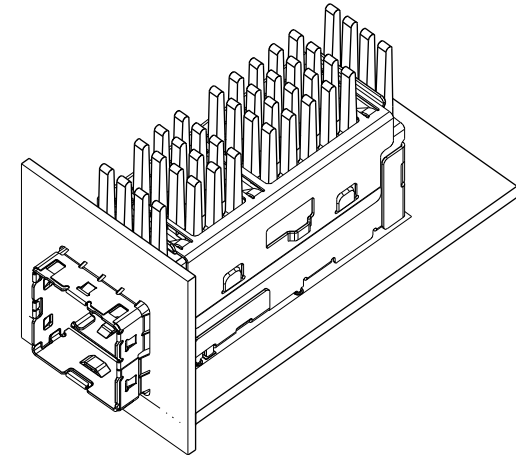

10112629-101 & 101LF WITH HEAT SINK
(HEAT SINK AND HEAT SINK MOUNTING CLIP FINAL ASSEMBLY BY CUSTOMER)

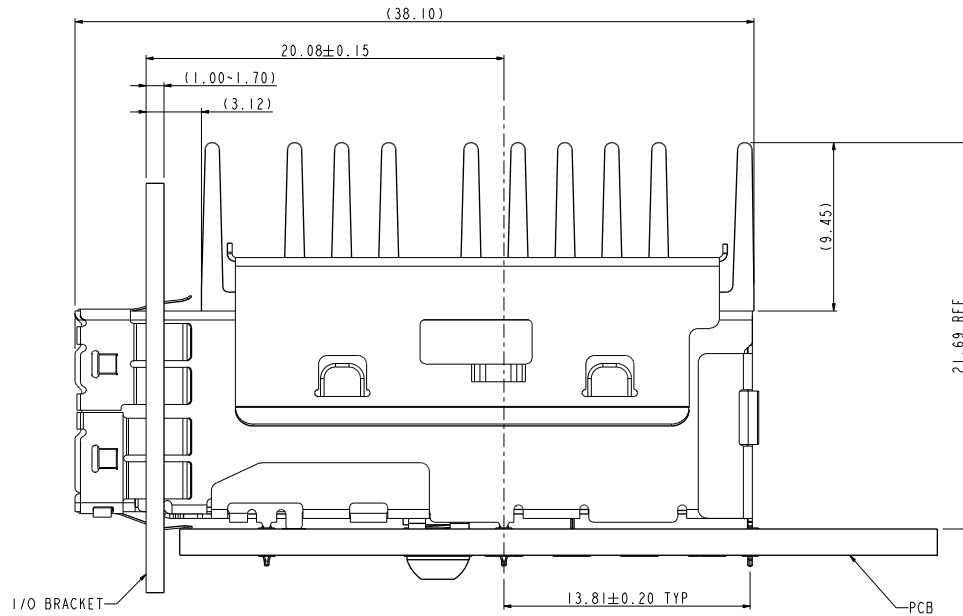

ASSEMBLED VIEW WITH HEAT SINK

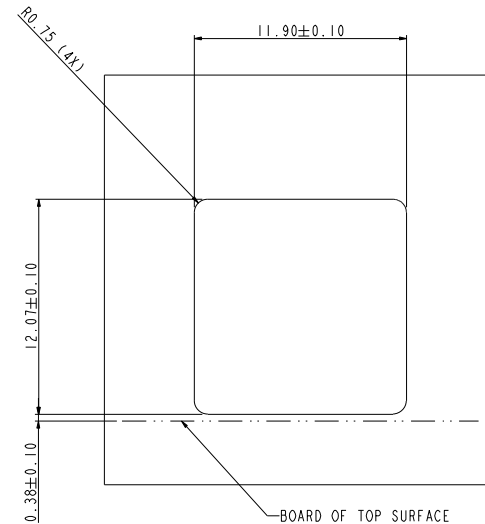

I/O BRACKET CUT OUT (BRACKET NOT SUPPLIED)

Copyright FCI.

spec ref	-	dr	Benny Chen	2012-05-07	projection	MM	size	A2	scale	1.000
tolerance std	ISO 406 ISO 1101	TOLERANCES UNLESS OTHERWISE SPECIFIED		eng	De-Feng Qin	2013-03-01	ecn no			
surface	✓	linear	0.X	±0.50	chr	Jon Qin	2013-03-01	rel level		
			0.XX	±0.30	appr	Pei-Ming Zheng	2013-03-01	product family	MINI-SAS HD	
		angular	0°	±3°	FCI		title	1x1 EXTERNAL ASSEMBLY WITH HEAT SINK	10112629	rev
					www.fci.com		cat. no.			A
					Product - Customer Drw					sheet 2 of 6

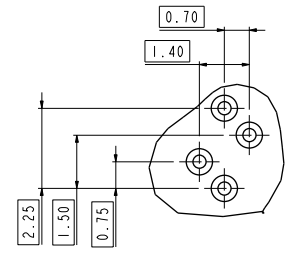
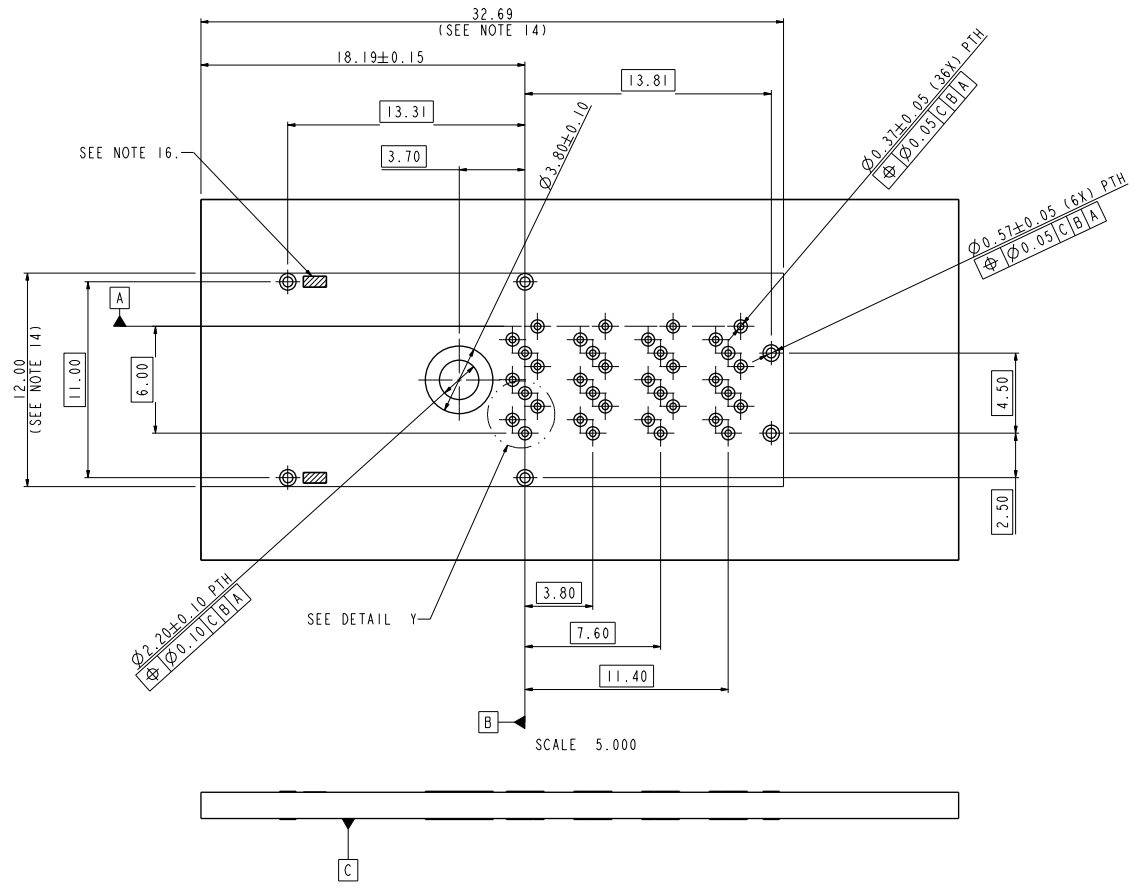

DETAIL Y
SCALE 10.000

SCALE 5.000

RECOMMENDED BOARD LAYOUT
SEE SFF-8644 FOR DETAIL

NOTES:

9. RECOMMENDED DRILL SIZE FOR Ø0.37 FINISHED PTH IS Ø0.457.
10. RECOMMENDED ANNULAR RING AROUND Ø0.37 FINISHED PTH IS Ø0.73.
11. RECOMMENDED DRILL SIZE FOR Ø0.57 FINISHED PTH IS Ø0.68.
12. RECOMMENDED ANNULAR RING AROUND Ø0.57 FINISHED PTH IS Ø0.93.
13. MINIMUM RECOMMENDED CENTER TO CENTER SPACING BETWEEN ADJACENT CONNECTORS: 14.00mm.
14. CONNECTOR KEEP OUT AREA.
15. MINIMUM PCB THICKNESS: 1.57mm.
16. CAGE STAND OFF AREA, NO TRACES ON SURFACE OF PCB IN THE AREAS.

Copyright FCI

spec ref	-	dr	Benny Chen	2012-05-07	projection	MM	size	A2	scale	1.000
tolerance std	ISO 406 ISO 1101	eng	De-Feng Qin	2013-03-01			ecn no	-	rel level	-
TOLERANCES UNLESS OTHERWISE SPECIFIED		chr	Jon Qin	2013-03-01						
surface	linear	0.X	±0.50		title Ix1 EXTERNAL ASSEMBLY WITH HEAT SINK MINI-SAS HD	cat. no. -	diag no 10112629	rev A	Product - Customer Drw	
	angular	0°	±3°						sheet 3 of 6	
ISO 1302										

RECOMMENDED KEEP OUT AREAS

RECOMMENDED INSERTION TOOL
KEEP OUT AREA
NO COMPONENTS IN THIS AREA
MORE THAN 7.50mm TALL

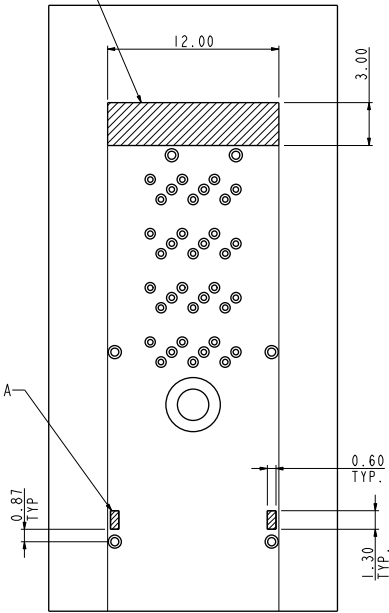

CAGE STAND OFF KEEP OUT AREA

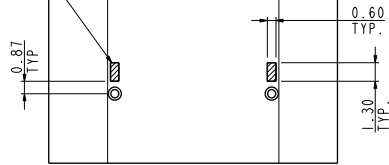

SCALE 4.000

RECOMMENDED EXTRACTION TOOL
KEEP OUT AREA
NO COMPONENTS IN THESE AREAS

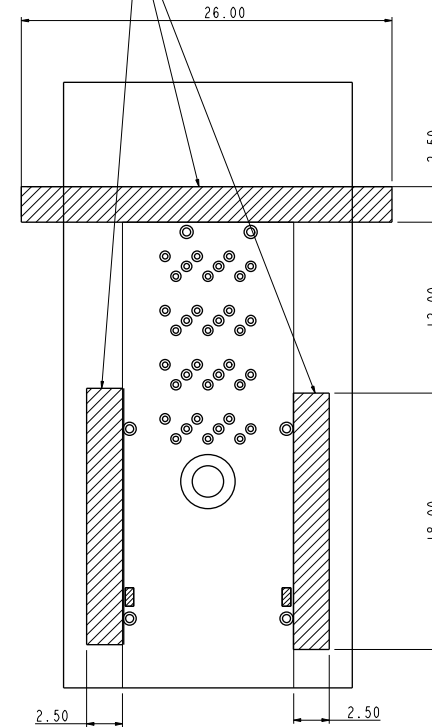

SCALE 4.000

Copyright FCI.
FCI

spec ref	-	dr	Benny Chen	2012-05-07	projection	MM	size	A2	scale	1.000												
tolerance std	ISO 406 ISO 1101	eng	De-Feng Qin	2013-03-01			ecn no															
TOLERANCES UNLESS OTHERWISE SPECIFIED		chr	Jon Qin	2013-03-01			product family	MINI-SAS HD	rel level													
surface	<table border="1"> <tr> <td>linear</td> <td>0.X</td> <td>±0.50</td> </tr> <tr> <td></td> <td>0.XX</td> <td>±0.30</td> </tr> <tr> <td></td> <td>0.XXX</td> <td>±-</td> </tr> <tr> <td>angular</td> <td>0°</td> <td>±3°</td> </tr> </table>	linear	0.X	±0.50		0.XX	±0.30		0.XXX	±-	angular	0°	±3°	appr	Pei-Ming Zheng	2013-03-01	title	1x1 EXTERNAL ASSEMBLY WITH HEAT SINK	cat. no	10112629	rev	A
linear	0.X	±0.50																				
	0.XX	±0.30																				
	0.XXX	±-																				
angular	0°	±3°																				
ISO 1302		www.fcicom			Product - Customer Drw	sheet 4 of 6																

PIN OUT DESIGNATIONS

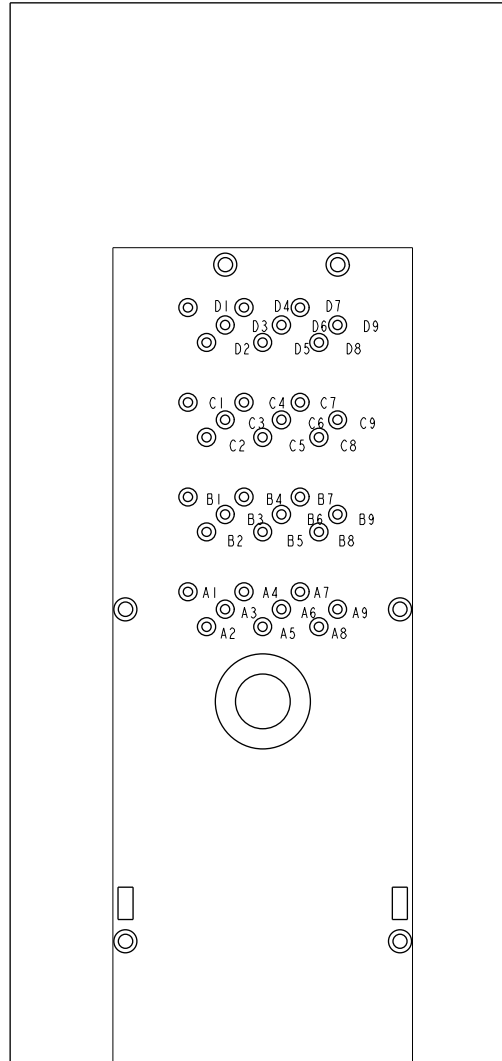

SCALE 7.000



Copyright FCI.

spec ref	-	dr	Benny Chen	2012-05-07	projection	MM	size	A2	scale	1.000
tolerance std	ISO 406 ISO 1101	eng	De-Feng Qin	2013-03-01			ecn no	-		
TOLERANCES UNLESS OTHERWISE SPECIFIED		chr	Jon Qin	2013-03-01			product family	MINI-SAS HD	rel level	-
surface	linear	appr	Pei-Ming Zheng	2013-03-01						
ISO 1302	angular	www.fcj.com		cat. no.	-	Product - Customer Drw	10112629	A	sheet 5 of 6	

1

2

3

4

5

6

7

8

A

B

C

D

E

F

A

B

C

D

E

F

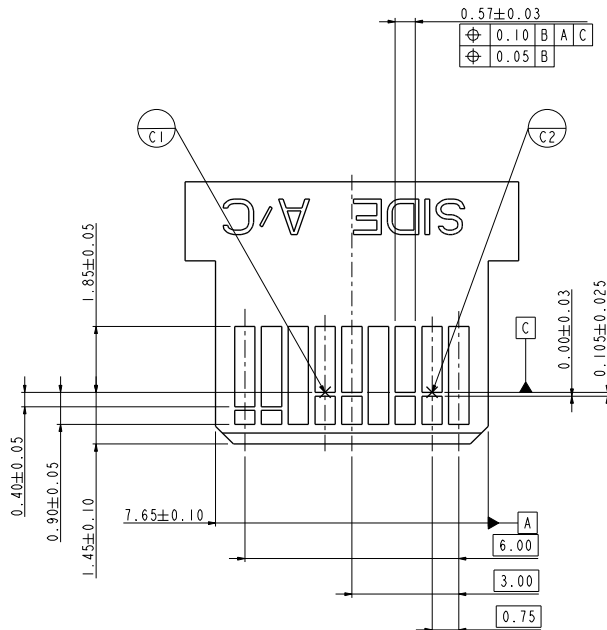
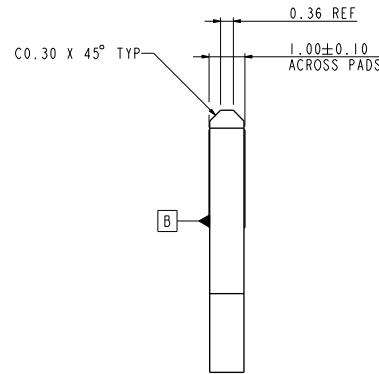
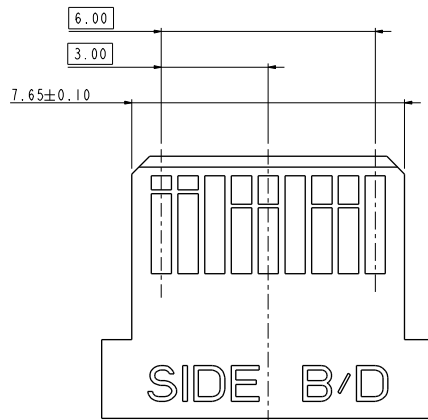

RECOMMENDED PLUG PADDLE CARD
SEE SFF-8644 FOR DETAIL



Copyright FCI.

NOTES:

- 17. 0.05 MINIMUM KEEP OUT FOR SOLDER MASK AROUND ALL PADS.
- 18. DATUM C TARGETS ARE DEFINED BY THE RESPECTIVE PAD CENTER LINES AND THE LEADING EDGE OF THE TARGET PADS.

spec ref	-	dr	Benny Chen	2012-05-07	projection	MM	size	A2	scale	1.000
tolerance std	ISO 406 ISO 1101	eng	De-Feng Qin	2013-03-01			ecn no	-		
TOLERANCES UNLESS OTHERWISE SPECIFIED		chr	Jon Qin	2013-03-01			rel level	-		
surface	linear 0.X ±0.50 0.XX ±0.30 0.XXX ±- angular 0° ±3°	appr	Pei-Ming Zheng	2013-03-01	product family	MINI-SAS HD	cat. no	10112629	rev	A
ISO 1302		www.fci.com							Product - Customer Drw	sheet 6 of 6