

Tous droits strictement reserves. Reproduction ou communication a des tiers interdite sous quelque forme que ce soit sans autorisation ecrite du proprietaire. Propriete de c FCI. Droits de reproduction FCI.

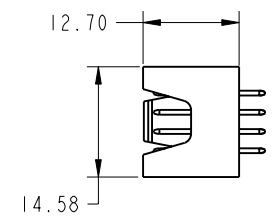

All rights strictly reserved. Reproduction or issue to third parties in any form whatever is not permitted without written authority from the proprietor. Property of FCI. Copyright FCI.

PRODUCT NO.	ROWS	POWER					SIGNAL					
		P1	P2	P3	P4	P5	1	2	3	4	5	6
51716-002-- NOTE ③	D C B A	PA	PA	PA	PA	X	E	E	E	E	E	E

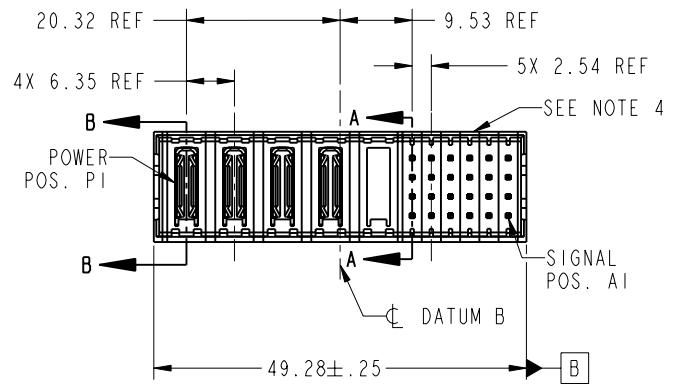

CODE	DIM "M" MATING LENGTH	CONTACT TYPE
PA	[N/A]	POWER
E	[6.86]	SIGNAL
X	OMITTED	OMITTED

mat'l code				tolerances unless otherwise specified				CUSTOMER		CONFIDENTIAL	
ltr	ecr no.	dr	date	linear	0.X ± 0.3		COPY		www.fciconnect.com		
A	DG06-0245	JMG	06/21/06		0.XX ± 0.10		projection		title		
				angles	0.XXX ± 0.050				5P + 24S		
				dr	JM GUO	06/21/06			VERTICAL STB HEADER WITHOUT GUIDE POST		
				engr	SLUO	06/21/06	MM		product family PwrBlade		
				chr	BEER FU	06/21/06			code		
				appd	JOSEPH HSIA	06/21/06	scale 1:1		213		
sheet index	revision sheet	A	A	A	A				size		
		1	2	3	4				dwg no		
									51716-002		
									sheet 1 of 4		
									cage code		
									22526		

Tous droits strictement reserves. Reproduction ou communication a des tiers interdite sous quelque forme que ce soit sans autorisation ecrite du proprietaire. Propriete de c FCI. Droits de reproduction FCI.



All rights strictly reserved. Reproduction or issue to third parties in any form whatever is not permitted without written authority from the proprietor. Property of FCI. Copyright FCI.

PRODUCT NUMBER
51716-002__
NOTE 3

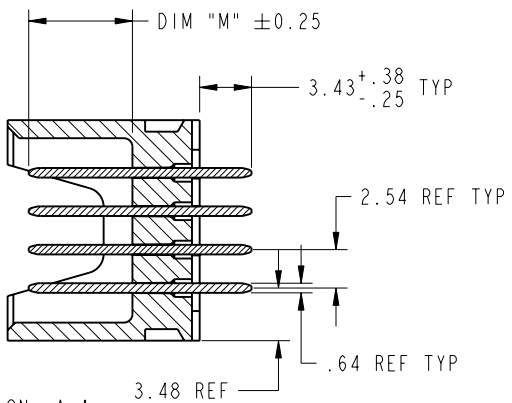

SECTION A-A
SCALE 2:1

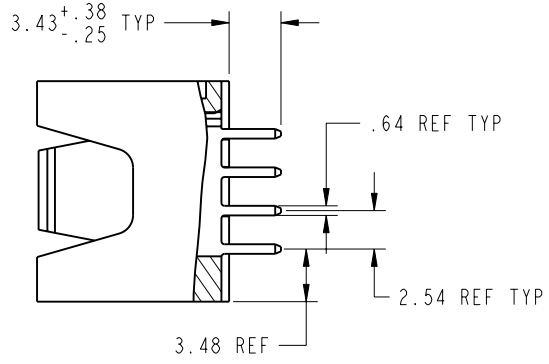

SECTION B-B
SCALE 2:1

CONFIDENTIAL

mat'l code				tolerances unless otherwise specified		CUSTOMER		FCI www.fciconnect.com	
lfr	ecr no.	dr	date	linear	0.X ±0.3		COPY		title 5P + 24S VERTICAL STB HEADER WITHOUT GUIDE POST
A					0.XX ±0.10		projection		
					0.XXX ±0.050				
				angles	0° ±2°				product family PwrBlade code 213 sheet 2 of 4
				dr	JM GUO	06/21/06	MM		
				engr	SLUO	06/21/06			
				chr	BEER FU	06/21/06	scale 1:1		size A
				appd	JOSEPH HSIA	06/21/06			dwg no 51716-002
sheet index	revision sheet								cage code 22526

Pro/E

Tous droits strictement reserves. Reproduction ou communication a des tiers interdite sous quelque forme que ce soit sans autorisation ecrite du proprietaire. Propriete de c FCI. Droits de reproduction FCI.



All rights strictly reserved. Reproduction or issue to third parties in any form whatever is not permitted without written authority from the proprietor. Property of FCI. Copyright FCI.

PRODUCT NUMBER
51716-002__
NOTE 3

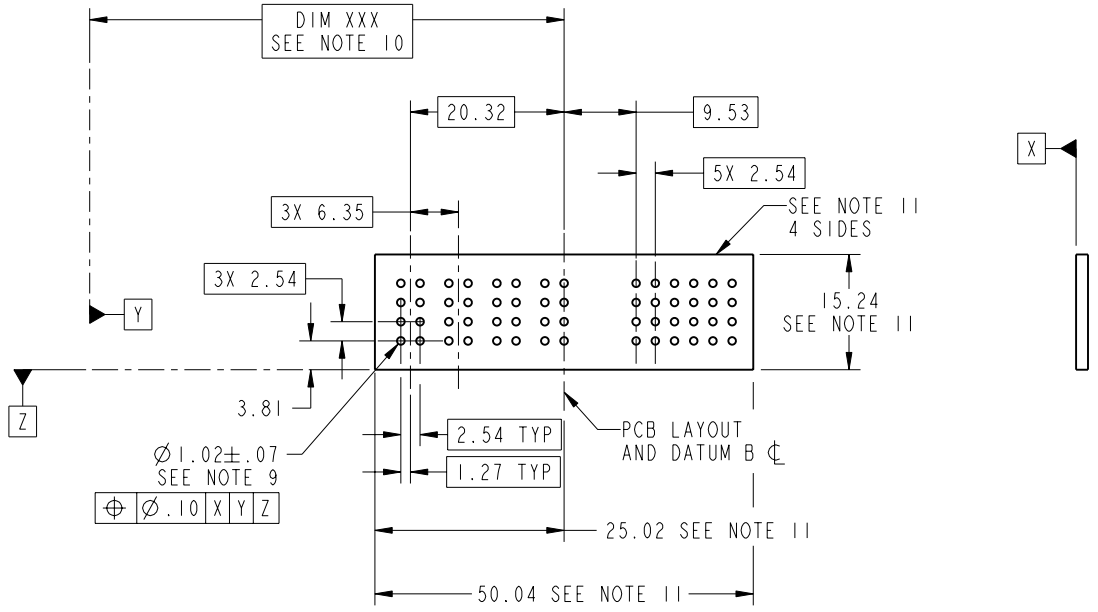

CONFIDENTIAL

mat'l code				tolerances unless otherwise specified		CUSTOMER		FCI www.fciconnect.com	
lfr	ecr no.	dr	date	linear	0.X ± 0.3	COPY		title	
A					0.XX ± 0.10	projection		5P + 24S	
				angles	0.XXX ± 0.050	MM		VERTICAL STB HEADER WITHOUT GUIDE POST	
				dr	JM GUO 06/21/06	scale		product family PwrBlade code	
				engr	SLUO 06/21/06	1:1		size 213	
				chr	BEER FU 06/21/06			dwg no 51716-002	
				appd	JOSEPH HSIA 06/21/06			sheet 3 of 4	
sheet index		revision sheet							

cage code 22526

Pro/E

Tous droits strictement réservés. Reproduction ou communication à des tiers interdite sous quelque forme que ce soit sans autorisation écrite du propriétaire. Propriété de c FCI. Droits de reproduction FCI.



All rights strictly reserved. Reproduction or issue to third parties in any form whatever is not permitted without written authority from the proprietor. Property of FCI. Copyright FCI.

PRODUCT NUMBER

51716-002--
NOTE 3

NOTES:

1. DIMENSIONS AND TOLERANCES ARE IN ACCORDANCE WITH ASME Y14.5M, 1994 UNLESS OTHERWISE SPECIFIED.

CONNECTOR NOTES:

- ② HOUSING MATERIAL: UL 94 V-0 GLASS FILLED HIGH-TEMP THERMOPLASTIC
POWER CONTACT MATERIAL: COPPER ALLOY
SIGNAL PIN MATERIAL: COPPER ALLOY
 - 3. PLATING:
51716-002 ,51716-002LF PLATING SPEC. WAS SHOWN IN THE PRINT OF 10064183.
 - ④ MANUFACTURER'S NAME, P/N, AND DATE CODE TO APPEAR ON THIS SURFACE.
 - 5. PRODUCT SPECIFICATION GS-12-149.
APPLICATION SPECIFICATION BUS-20-067.
 - 6. PACKAGED IN TRAYS.
- PCB NOTES:**
- 7. ALL HOLE DIAMETERS ARE FINISHED HOLE SIZE.
 - 8. MOUNTING HOLES, WHERE APPLICABLE, ARE UNPLATED.
 - ⑨ $\varnothing 1.151 \pm 0.025$ DRILLED HOLES PLATED WITH 0.008 MIN SnPb OVER .001 [0.03] TO 0.08 Cu PLATING TO ACHIEVE $\varnothing 1.02 \pm .07$ HOLE.
 - ⑩ "DIM XXX" TO BE DETERMINED BY THE CUSTOMER.
 - ⑪ CONNECTOR KEEP-OUT ZONE.

CONFIDENTIAL

mat'l code				tolerances unless otherwise specified		CUSTOMER		FCI www.fciconnect.com	
ltr	ecr no.	dr	date	linear	0.X ±0.3	COPY		title	
A					0.XX ±0.10	projection		5P + 24S	
				angles	0.XXX ±0.050			VERTICAL STB HEADER WITHOUT GUIDE POST	
				dr	JM GUO 06/21/06	MM		product family PwrBlade code	
				engr	SLUO 06/21/06			size 213	
				chr	BEER FU 06/21/06	scale		dwg no 4 of 4	
				appd	JOSEPH HSIA 06/21/06	1:1		A 51716-002	
sheet index	revision sheet								

Pro/E

code code 22526

PDM: Rev:A

STATUS: **Released**

Printed: Dec 20, 2010