

Miniature

→ 83 137 0

- Action with a wire
- Very low operating force
- Long mechanical life



Main specifications

		With standard rotary action 83 137 0
Function	Connections	
I (changeover)	W3	
I (changeover)	W2	83 137 004
R (normally closed)	W2 - W3	●
C (normally open)	W2 - W3	●
Electrical characteristics		
Rating nominal / 250 V AC (A)		5
Rating thermal / 250 V AC (A)		14
Mechanical characteristics		
maximum operating force N cm		0.12
Minimum release torque N cm		0.03
Overtravel torque N cm		0.5
Pre-travel- maximum (°)		26
Maximum differential travel (°)		14
Min. overtravel (°)		12
Ambient operating temperature (°C)		-20 → +125
Mechanical life (operations)		10 ⁷
Contact gap (mm)		0.8
Weight (g)		7.2

Additional specifications

Components

Material

- Case : polyamide.
- Contacts : silver.

Lever

- Stainless steel wire.

Product adaptations



- Special levers
- UL approval

Principles

Single break changeover switch

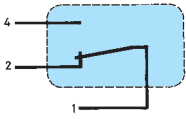

Curves

Operating curve for type 83 137 0

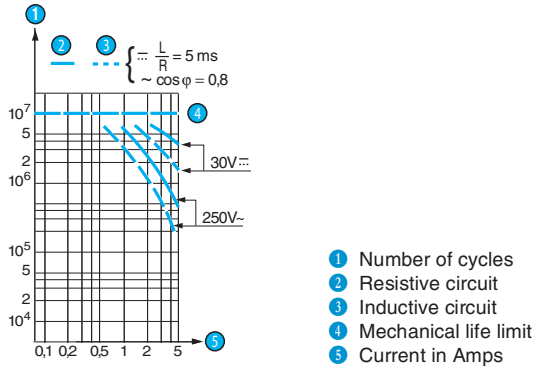

Dimensions

→ Product

83 137 0

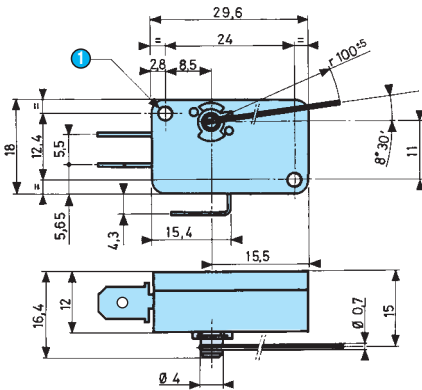

1 2 holes Ø 3.2

→ Connections

W2 solder

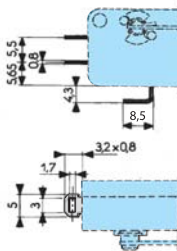

W3 for 6.35 mm clips

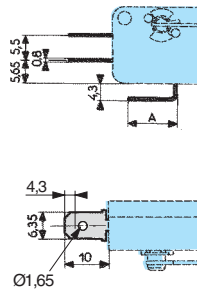

Other information

Mounting - Operation

See basic technical concepts