

FLUKE®

CNX a3000

Wireless AC Clamp

Quick Reference Guide

⚠️ Warning

To prevent possible electrical shock, fire, or personal injury, read the "CNX a3000 Safety Information" before you use this Product.

Go to www.fluke.com to register your product and find more information.

Amps

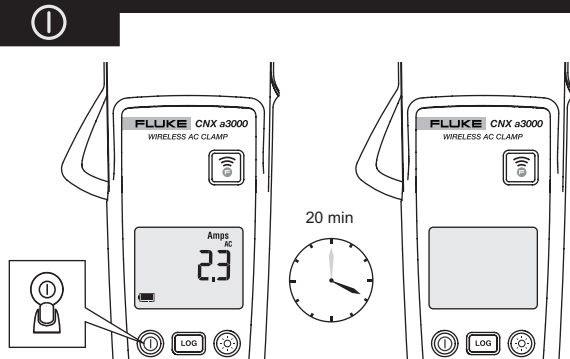
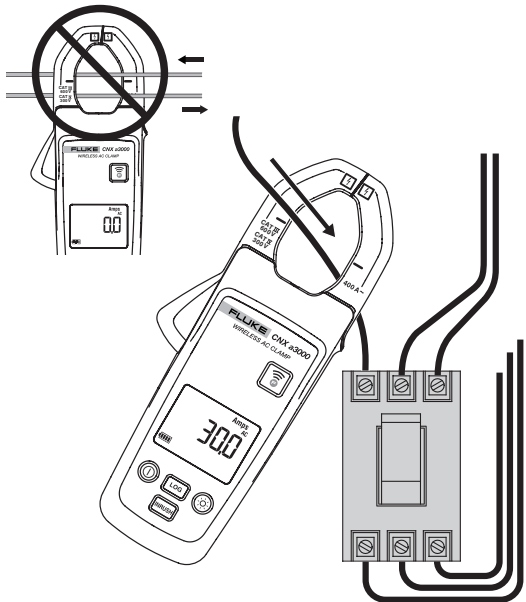

1 OFF	2 LOG + [Power]	3 LOG x2	4 PoFF
5 [Light]	6 Amps AC 2.3 ∞	7 [Light]	8 Amps AC 2.3 ∞

Settings

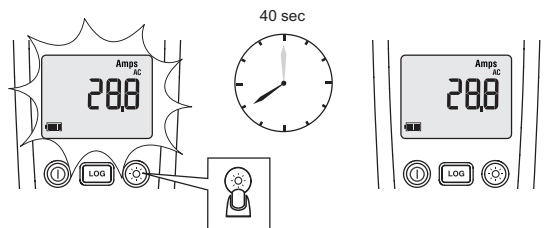

1 OFF	2 LOG + [Power]	3 LOG x3	4 LoFF
5 [Light]	6 Amps AC 28.8 ∞	7 [Light]	8 Amps AC 28.8 ∞

INRUSH

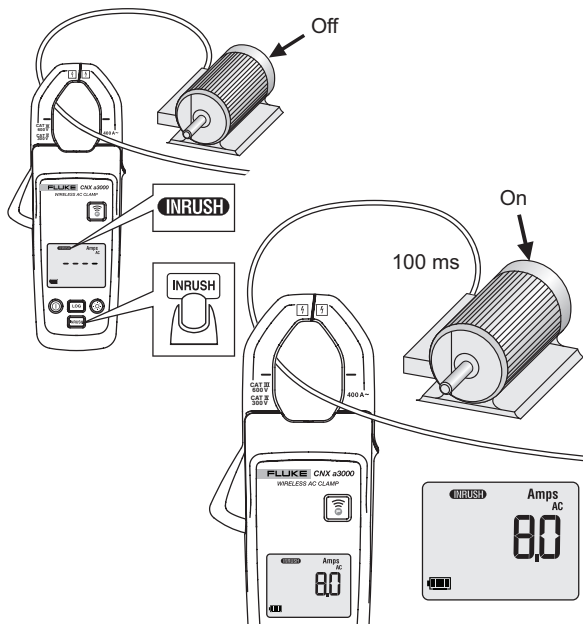

LOG

